

MORE **LIFE** IN YOUR **GARDEN**

GARDEN HOUSES • HOLIDAY HOUSES • PAVILIONS
GARAGES • CHILDREN'S PLAY HOUSES • ACCESSORIES

SELECTION 2021



www.lasita.com

ABOUT US



Quality

- 5 years warranty on wooden construction
- ISO 9001 certified quality management
- High-quality timber
- State-of-the-art processing
- Decades of experience
- Individually configurable holiday home program



Building kit

- Up to 92 mm wall thickness available
- Solid wood roof and floor
- High-quality laminated wood doors and windows with insulating glazing as an option
- Doors and windows are also available finish treated on request (please see page 4-5)
- All parts prefabricated
- Easy assembly with clear instructions
- Safe transport packaging
- Cabins come with fixing kit



Service

- Delivery to kerbside
- Short delivery times for stock items
- Competent service team on site or by telephone
- Assembly service on request
- Submission and planning documents with 3D drawings available on request.

Dear customer,

Our garden – the refuge where we can enjoy our free time and leave behind everyday life. This is the home of our garden buildings. It does not matter whether you need a secure storage space for your gardening tools, a place to celebrate or enjoy your barbecue, to let your feet dangle on the patio, or whether it is a place where children can play and have fun and simply be children. Regardless of what the use of your garden paradise will be, you will definitely find the right idea in our wide range of garden buildings, garages, element houses, children's play houses and weekend houses.

Lasita Maja Team

NEW LASITA COLOUR SYSTEM

In 2020 Lasita Maja invested heavily in its manufacturing facility

As part of our investment we are extremely proud to be able to offer our customers our cabins with a range of colours painted on what we believe is the most modern paint line in Europe

With our state of the art production facility we are set up to offer our customers the very best service into 2021 and beyond!

Our almost fully automated colouring machine can coat the wall logs with 3-sided protection. With inside untreated material we keep alive the natural look and feel of your product when you step inside. In case of log cabins with traditional chalet corners we can seal the edges connections on 6-sides. This set-up is unique in industrially produced log cabins on the market and provides best protective use for many years of gardening joy.

When the decision was made to invest in the new paint line the next decision to make was which treatment we would use.

OSMO were the perfect fit for us. They offered unrivalled quality and experience having worked with wood treatments for over 50 years.

Their reputation for quality and reliability is unsurpassed and our customers can be sure that when they order a cabin treated from the new paint line they are getting a cabin with a touch of German engineering as the finishing touch!



TABLE OF CONTENT

MODEL

PAGE

DOMEO SERIES

10-29

Domeo 1.....	14
Domeo 2.....	15
Domeo 3.....	16
Domeo 3 Loggia.....	17
Domeo 4.....	18
Domeo 4 Loggia.....	19
Domeo 5.....	20-21
Domeo 6.....	22
Domeo 6 Loggia.....	23
Domeo 7.....	24
Domeo 8.....	25
Domeo 9.....	26
Domeo 10.....	27
Internal room kit.....	28-29

HOME OFFICES

30-35

Dorset 2/3.....	31
Dorset 71/72/73.....	33
Sussex.....	32
Sussex 2.....	32

GARDEN BUILDINGS

36-77

Alex.....	72-73
Alex mini.....	74
Alexandra.....	71
Aruba range.....	43-45
Barbados range.....	53-54
Baruda 53.....	75
Berkshire 43/44.....	68
Borkum 2.....	40
Borkum 4.....	41
Brighton 44.....	58
Bristol.....	71
Carlisle.....	52
Caroline range.....	62-67
Chameleon.....	76
Cortina.....	37
Devonshire 43.....	70
Dominica.....	56-57
Dorset.....	50-51
Dundee 44.....	45
Edingurgh 2.....	42
Elgin 44.....	74
Gotland range.....	46-47
Hampshire.....	59
Japan.....	55
Java.....	55
Jubilee 44.....	75
Norderney 2.....	39
Norderney 3.....	38
Oban 40.....	48-49
Orkney.....	60
Portsmouth 44.....	77
Torquay.....	61
Wrexham 1/2.....	69

VICTORIAN STYLE

78-81

Kensington.....	79
Pembrokeshire 53.....	79
Sri Lanka.....	80
Windsor 44.....	81

MODEL

PAGE

GARAGES

82-87

Canberra.....	85
Falkland.....	86
Hawaii.....	84
Nevis.....	87

PAVILLIONS

88-93

Ilmenau.....	90
Inverness.....	91
Jamaica.....	92-93

HOLIDAY HOUSES

94-123

Canada.....	102
Ceylon.....	110
Elba.....	117
Eufrat.....	104
Exeter range.....	114-115
Ganges.....	105
Grossglockner.....	111
Han.....	109
Kasai A.....	108
Lyndhurst.....	118
Mälaren.....	106
Malmö.....	95
Matterhorn.....	112
Mekong.....	98
Mekong XL.....	100-101
Missouri.....	103
Mont Blanc.....	113
Örebrö.....	96
Öregrund.....	122-123
Östersund.....	124-125
Staffordshire 1/2.....	116
Tahiti 70.....	119
Värnamo.....	107
Zanzibar 1.....	120
Zanzibar 4.....	121

PLAYHOUSES

126-127

Lido.....	126-127
-----------	---------

ACCESSOIRES

128-131

Additional doors and windows.....	131
Door handles.....	129
Eaves gutters.....	129
Flower boxes.....	129
Maintenance paint.....	131
Onduline.....	130
Roof extensions.....	128
Roof shingles.....	130
Roofing felt basic.....	130
Roofing felt premium.....	130
Solar light kit.....	129
Terraces.....	128
The Bar.....	128
Window shutters.....	129

Domeo Series

10



Home Office

30



Garden Buildings

36



Victorian Style

78



Garages

82



Pavilions

88



Holiday Houses

94



Children's Play Houses

124



Accessories

120



SILVER



GOLD



WINDOWS*

1	Wood species	Spruce	Spruce
2	Wall thickness mm	28 / 34 / 40 / 44	34 / 40 / 44
3	Laminated wood	+	+
4	Cross bars	(with) Screws	(with) Screws
5	Glazing	Single (4 mm)	Double (3 / 6 / 3)
6	Code	SGC / MGC	DGP+
7	U-Value > W/m ² K	5.6	3.3
8	Silicone gasket	-	+
9	Water gutter	Wood	Aluminium
10	Window opening	Inward	Inward / outward
11	Opening system	2 hand tilt & turn	2 hand tilt & turn
12	Frame profile for installation	-	-
13	Final treatment	-	-
14	Tempered glass	+	+



DOORS*

1	Wood species	Spruce	Spruce
2	Wall thickness mm	28 / 34 / 40 / 44	34 / 40 / 44
3	Laminated wood	+	+
4	Cross bars	(with) Screws	(with) Screws
5	Glazing	Single (4 mm)	Double (3 / 6 / 3)
6	Code	SGC / MGC	DGP+
7	U-Value > W/m ² K	5.6	3.3
8	Silicone gasket	-	+
9	Door threshold	Aluminium	Aluminium / coated metal
10	Door opening	Outward	Outward
11	Locking system	Cylinder	Cylinder
12	Frame profile for installation	-	-
13	Final treatment	-	-
14	Tempered glass	+	+



CONSTRUCTION*

1	Wall thickness mm	28 / 34 / 40 / 44	40 / 44
2	Wind tight chalet connection	+	+
3	Wall insulation	-	Optional
4	Double tongue and groove	From 34 mm	+
5	Impregnated foundation beams	+	+
6	Floor boards 18 mm	+	+
7	Floor boards 28 mm	-	-
8	Floor insulation	-	-
9	Roof boards	18 mm	18 mm
10	Roof construction	Purlins	Purlins / rafters
11	Roof insulation	-	-
12	Construction for roof tiles	-	-
13	Wind protection device	Wooden strip	Threaded rod
14	Warranty for construction	5 years	5 years



PLATINUM



DIAMOND



DIAMOND



Pine	Pine	Pine
44 / 70 / 92	44 / 70 / 92	44 / 70 / 92
+	+	+
(with) Screws	(with) Screws	(with) Clips
Double (4 / 14 / 4)	Double (4 / 14 / 4)	Double (4 / 18 / 4)
2+	3+	5+
2.8	2.8	1.1
+	+	+
Aluminium	Aluminium	Aluminium
Inward	Inward	Inward
2 hand tilt & turn	1 hand tilt & turn	1 hand tilt & turn
Included from 70 mm	Included from 70 mm	Included from 70 mm
-	-	Finished
+	+	+



Pine	Pine	Pine
44 / 70 / 92	44 / 70 / 92	44 / 70 / 92
+	+	+
(with) Screws	(with) Screws	(with) Clips
Double (4 / 8 / 4)	Double (4 / 14 / 4)	Double (4 / 18 / 4)
2+	3+	5+
3.0	2.8	1.1
+	+	+
Aluminium / coated metal	Aluminium / coated metal	Aluminium / coated metal
Outward	Outward / inward	Outward / inward
Cylinder	Multiple locking	Multiple locking
Included from 70 mm	Included from 70 mm	Included from 70 mm
-	-	Finished
+	+	+



44 / 70 / 92	44 / 70 / 92	44 / 70 / 92
+	+	+
Optional	Optional	Optional
+	+	+
+	+	+
Optional	Optional	Optional
+	+	+
Optional	Optional	Optional
18 mm	18 mm	18 mm
Purlins / rafters	Purlins / rafters	Purlins / rafters
Optional	Optional	Optional
Optional	Optional	Optional
Threaded rod	Threaded rod	Threaded rod
5 years	5 years	5 years

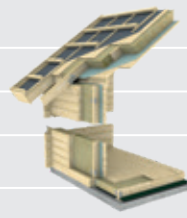
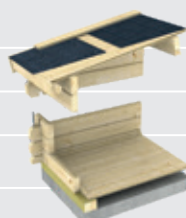

WITH A GOOD CONSCIENCE

Every garden building starts with an idea, with your idea of the perfect product. Just as important as these thoughts are the small details of the finished product later on. Therefore it is important to provide the right quality. We select the best Nordic wood, we use modern processing techniques combined with traditional hand crafted ones and secure packaging. All of these features are what makes our products special.

BEST QUALITY

We have established a quality management system in compliance with the ISO-9001 norm, so that we can offer top quality to our customers. In addition, our products come with either a 2-year or 5-year warranty.

CERTIFIED WOOD

We use only selected Nordic wood for all our garden buildings. Nordic wood, with its flexible properties is perfect for the use as building and construction. It grows slowly in colder regions of Europe and thus it is especially stable and robust reliability, longevity, structural strength and aesthetic look it lends to our cabins. Wood is sustainable and renewable raw material. We support ecological and responsible timber manufacturing. For this reason our raw material management also supplies FSC®-certified wood on request.



Ask about FSC® certified products

PROCESSING

To be able to supply unique products to you, we rely on our long-time employees with plenty of experience and on our modern machinery. Trained eyes inspect and sort the materials and building components. Our machines saw, plane and mill the individual parts with millimetre accuracy into the correct size and desired shape. Before the final consignment everything is inspected again and then carefully and securely packed.

USING QR-CODES

In our catalogue you will find some QR-Codes. “QR” stands for “Quick Response” and makes it simple to access links and data fast and easy with your mobile phone. Just hold your camera over the code and scan it. You will be automatically redirected to the corresponding data set or weblink. There is no need to type long addresses in your browser or remember any links. Just give a try and enjoy our brand-new content.



lasita.com



About us



ASSEMBLY KIT

Your garden building is delivered as a complete assembly kit in either one or several packages – depending on the size. Inside the assembly kit your garden house is systematically stacked onto a one-way pallet, its completeness is inspected and then all high-quality details are securely packed. Of course, each package contains detailed assembly instructions. We suggest you only unwrap the package from its foil when you want to commence building, as the foil is designed to protect the timber against the weather. If you do not start with the assembly right after your garden house has been delivered, please store it in a dry and UV-protected location.

WARRANTY

We are absolutely confident of our products. Therefore our garden houses come with either a 2-year or 5-year manufacturer's warranty. This warranty does not apply to unforeseeable natural catastrophes and storm damage caused by wind speeds of more than 60 km/h. There are supplied with each building the assembly instructions and warranty conditions, which are also available from our dealerships.

DELIVERY

You can choose to have your products delivered to your nearest dealer or directly to your home – delivered "kerbside". Your specialist dealer will be glad to calculate your specific and detailed offer. A day and time will be arranged with you before the delivery. Please note that the vehicles used are very large. Access for this type of vehicles must be possible without restrictions, and this will be discussed with you prior to delivery.

ASSEMBLY

Your garden building is delivered as a simple self-assembly kit. All parts are pre-fabricated and can be assembled relatively simply and quickly. Every package contains detailed assembly instructions. You can also see an online video that shows the assembly. Only a few tools will be needed for the assembly – these tools are NOT part of the delivered package. We recommend that at least two people work together for the assembly. Please bear in mind: check before the purchase of our product, whether a building permit is required.

OUR SERVICE

Despite the best products and the most careful assembly, help may be needed in some cases. Our highly trained employees are available, if you have questions regarding the planning and assembly as well as warranty or order enquiries.



OUR NEW COLOUR SYSTEM



WHAT'S NEW?

- 3-sided protection of wallboards
- Inside untreated for natural look and feel
- Corner connection on log cabins 6-sided sealed for best protective use
- Colour from German high-quality supplier "Osmo" used
- Purlins untreated
- Roof boards are untreated

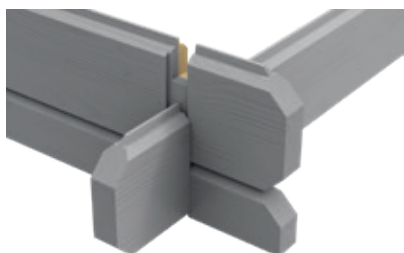

28 mm singlenut blockboard



34/44 mm doublenut blockboard



Four colours to choose.

Enjoy the benefits of our completely finished garden houses and forget about the burdensome painting of your precious cottage. That's why we have developed our new Lasita Maja colour system for you. Our industrial wood painting system provides ideal protection for your garden house for years - saving you valuable time and a lot of money.

Our environment-friendly and water-based wood preservative is ideal for professional outdoor use. Thanks to a unique combination of different binders, the surface is

ideally sealed whilst remaining breathable and permanently waterproof. The paint penetrates deep into the wood and its matte finish ensures a beautiful accentuation of the grain.

Our final treatment offers perfect protection against harmful weather conditions, UV radiation, insect infestation, mold, fungi and bluing.

Our wall boards are already treated on 3 sides (inside untreated for natural look and feel) using your desired colour. Our patented corner connection on log cabins is sealed 6 sided and provides best possible protection of wood and gives stability for years to come. Doors, windows and trimmings are painted cream white prior to shipping from the factory. Purlins and roof planks are untreated and give the cabin inside a natural look and feel.

As the components are already treated before installation, your garden house is well protected in the long run. Even the corner joints, cut edges and trimmings are properly treated. This helps maintain value and peace of mind for many years.

To repair any minor surface defects during assembly, each delivery comes with a paint supply for repairs.

Leave the paint work to others and go for a completely finished garden house from Lasita Maja.

FOUR COLOURS TO CHOOSE



FALU RED



GLACIERGREEN



CARBON GREY



LIGHT GREY

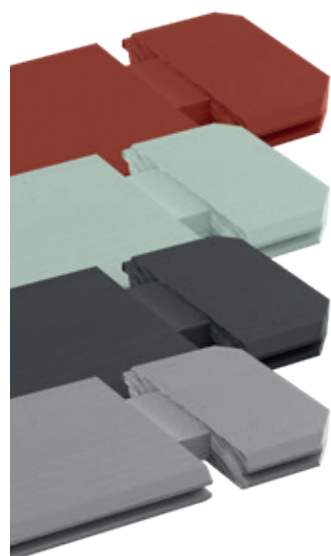

osmo[®]
...in form und farbe

For our new coating system, we are cooperating with the German major brand supplier "OSMO". They were founded more than 140 years ago and do work with wooden paintings already in the last 50 years. In their German factories about 350 employees work to ensure the high-quality demand of their partners

PRODUCT FEATURES

- All boards with industrial finish on three sides
- Log cabins blockboard heards and corner connections are 6-sided sealed for the best protective use
- Used colour is from OSMO
- Inside boards natural untreated
- 4 colours available
- Doors/windows are cream white inside and outside
- Trims and windows can be painted cream or white depending on what the client wants
- Purlins untreated
- Roof planks are untreated
- Environment-friendly, solvent-free and low-odour treatment agents
- Ideal protection against weather conditions, fungi, insect infestation, mould and bluing
- Paint supply for repairs included in delivery
- Recommended maintenance interval 5 years
- Lasita Maja warranty 5 years
- Paints can be ordered separately (for refinishing)

*Read more about our warranty conditions in assembly instructions or visit www.lasita.com

Note that the colours shown are from the actual execution, due to representation in printing inks, may differ.

If your customer wants to mirror a house that is coloured on three sides, please let us know when ordering.

worldwide. Their "Made in Germany" seal stands for the entire production chain in own factories. In this way OSMO can always guarantee high quality and in all production steps. With OSMO as partner we can ensure a best possible coating result and promise long life and protection of your wooden product.

Endless
options
of joy



DOMEQ

SERIES

Modern, clear and focused – this is our updated Domeo series. Glass and Aluminum in combination with wood and functional designs brings tons of options of use for you in your home and garden.

With the enlarged Domeo portfolio you have so many options for everyday use, office work at home, for a gym, bar, or relaxing and a way of expanding your living space.

DOUBLE GLAZING

All Domeo cabins come with double glazing and with improved, stronger frames in cobalt grey. These cabins are a good investment for all year around use, especially for countries with a milder climate. Thanks to the addition of 14 mm double/tempered window glazing the heat resistance is significantly increased and now its 47 % more energy efficient. Reducing your heating costs and keeping you nice and cozy in winter. The interaction of glued frames, double glazing and thicker sash profiles makes the sliding door much stronger and more stable. This leads to a big benefit for noise reduction to the inside. We have as well upgraded our locking system, which is now stronger, more durable and much safer to store your valuable possessions.

The large glass surfaces make it possible to have enough natural light inside the room and enjoy the beautiful view from inside out.

Since 2019 we introduced a range of single glazed aluminium frames, now we have further developed this and all models will be double glazed, but with an addition of certain models having superior insulated frames. These models are Domeo 7/8/9/10

DOORS AND WINDOWS

The new folding door of Domeo 8 and regular opening door of Domeo 7 have 28 mm double/tempered glazing and insulated frame. Please don't hesitate to ask about the insulation kits for our new Domeos!

To make it ultra-functional we provide a range of roof extensions. This is the perfect fit for creating a outside covered area and using it as BBQ areal or just enjoy fresh air.

We offer Domeo kits also in 70 mm wall thickness, which can be easily adapted to all year around use. Domeo 9 and 10 are perfect for a light filled living room or home office in the garden. Large Aluminium folding doors with 28 mm double/tempered glazing and insulated frame are almost completely openable. A spacious terrace-area is perfect for sunbathing or open-air gatherings with your family and friends in rainy days.



ALUMINIUM WINDOWS

- Designed as double glazed toughened to optimise the use of larger glazing areas, so as not to compromise on structural weight bearing
- Modern, virtually maintenance-free, long lasting and exceptionally resistant to weather conditions

LARGE GLASS SURFACES

- Make it possible for natural light to enter the room
- Provide views in different directions all year round

CONTEMPORARY YET FUNCTIONAL DESIGN

- Giving a minimalistic feel
- With a spacious light-filled interior
- Adding a touch of luxury to outdoor garden rooms

THE SLIDING DOOR

- Can be opened up to half or two-thirds of the way (depending on the model) which, in addition to its light-filled interior, allows it to be used as a pavilion style or an outdoor kitchen

DOMEQ

MODERN DESIGN WITH ALUMINIUM SLIDING DOORS

- ✓ Available door and window designs in cobalt grey
- ✓ Maintenance free doors and windows
- ✓ Specialist installers required
- ✓ Toughened double glazed units
- ✓ Long lasting minimalistic frames for 21st century lifestyle
- ✓ Door design is matched by contemporary cabin design
- ✓ Water tight corners protected by matching aluminium

Extend your Domeo with practical roof extension ideal as a BBQ area! It can be assembled left or right. Domeo 3 / 4 / 6 LOGGIA is non-extendable.

DOME

NARROW, MINIMALIST ALUMINIUM PROFILES

- Leave more room to enjoy the view outside



Assembly video



Assembly of fixed window





ULTRA-MODERN CUBE-SHAPED CABIN WITH ALUMINIUM SLIDING DOOR



DOMEO 1

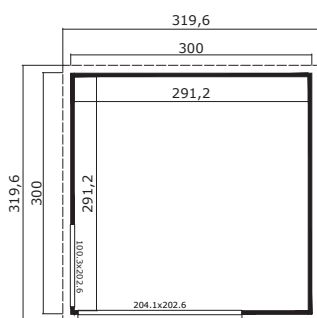

SET DOMEO 1 COBALT GREY	41262	44	300 X 300	8,48	20,3	239,4	239,4	9,8	9,59	204,1 X 202,6	100,3 X 202,6	1	-	✓
----------------------------	-------	----	-----------	------	------	-------	-------	-----	------	---------------	---------------	---	---	---



PRACTICAL ROOF CANOPY (INCLUDED IN SET) CAN BE ASSEMBLED LEFT OR RIGHT - OPTIMAL AS AN OUTDOOR KITCHEN



DOMEO 2

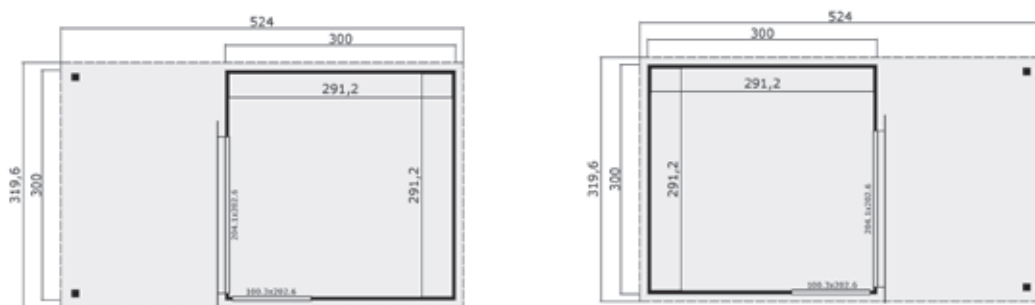

SET DOMEO 2 COBALT GREY	41267	44	300 X 300	8,48	20,3	239,4	239,4	214	15,71	204,1 X 202,6	100,3 X 202,6	2	-	✓
----------------------------	-------	----	-----------	------	------	-------	-------	-----	-------	---------------	---------------	---	---	---



MODERN CABIN DESIGN WITH TWO ROOMS AND WITH LIGHT FILLED INTERIOR



TIP! Extend your cabin with practical roof extension, which can be assembled on left or right.

DOMEO 3



ROOF EXTENSION



SET DOMEO 3 COBALT GREY	41272	44	322 X 509	15,67	37,51	239,4	239,4	9,8	17,18	303,9 X 202,6 204,1 X 202,6	83,5 X 195,7	100,3 X 202,6	2	-	✓
ROOF EXTENSION	9901200	44	300X322	9,3	-	222,3	239,4	10	9,75	-	-	-	1	-	-



MODERN CABIN DESIGN WITH TERRACE AND ROOF CANOPIES WITH TWO ROOMS AND WITH LIGHT FILLED INTERIOR



DOMEO 3 LOGGIA

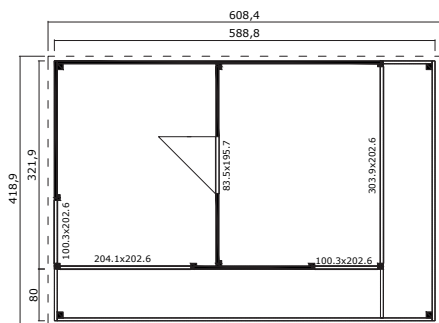

	Nº	44	589 X 322	22,8	52,63	239,4	239,4	10	24,47	303,9 X 202,6 204,1 X 202,6	83,5 X 195,7	100,3 X 202,6	2X15M + 1X10M	-	✓
DOMEO 3 LOGGIA	41292														



PERFECT FOR SPACIOUS AND LIGHT FILLED LIVING ROOM OR HOME OFFICE IN YOUR GARDEN



TIP! Extend your cabin with practical roof extension, which can be assembled on left or right.

DOMEO 4



ROOF EXTENSION

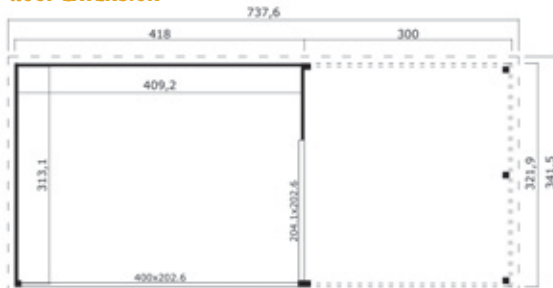

SET DOMEO 4 COBALT GREY	41277	44	322 X 418	12,82	30,68	239,4	239,4	9,8	14,22	400 X 202,6	204,1 X 202,6	2	-	✓
ROOF EXTENSION	9901200	44	300X322	9,3	-	222,3	239,4	10	9,75	-	-	1	-	-



PERFECT FOR SPACIOUS AND LIGHT FILLED LIVING ROOM, BRINGING THE OUTSIDE IN



DOMEO 4 LOGGIA

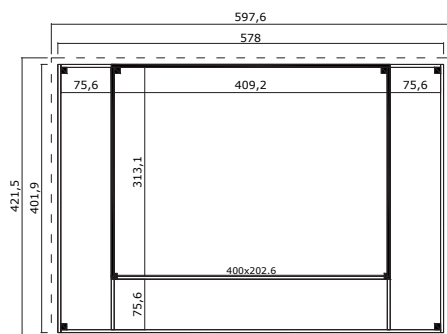

DOMEO 4 LOGGIA	41297	44	401,9 X 578	22,38	51,65	239,4	239,4	10	24,46	400 X 2026	83,5 X 195,7	-	2 X 15M + 1 X 10M	-	✓
----------------	-------	----	-------------	-------	-------	-------	-------	----	-------	------------	--------------	---	----------------------	---	---



LARGE GLAZING PANELS ON 3 WALLS PROVIDE VIEWS IN DIFFERENT DIRECTIONS ALL YEAR ROUND



DOMEO 5

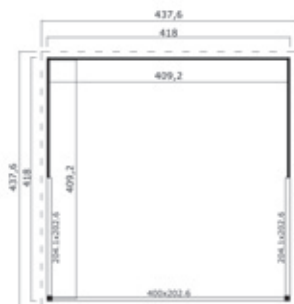

	Nº			m²	m³									
SET DOMEO 5 COBALT GREY	41282	44	418 X 418	16,74	40,09	239,4	239,4	9,8	18,38	400 X 202,6	204,1 X 202,6	-	3	✓
ROOF EXTENSION	9900300	44	300X418	12,1	-	222,3	239,4	10	12,6	-	-	-	1	-

DOMEO 5 WITH ROOF EXTENSION

TEMPERED
GLASS

DOMEO



EXTENDED SEATING AREA FOR THOSE RAINY DAYS, MAKING USE ALL YEAR AROUND



DOMEO 5 WITH ROOF EXTENSION



TIP! Extend your cabin with practical roof extension, which can be assembled on left or right.



SPACIOUS AND LIGHT FILLED CABIN FITS TO THE CORNER OF YOUR GARDEN USING UP MINIMUM SPACE GIVING YOU MAXIMUM ROOM



DOME 6

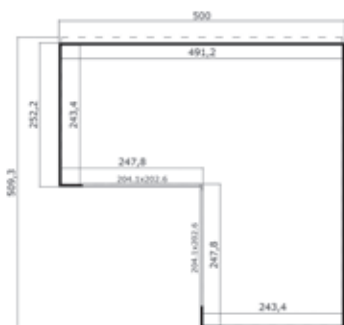

	SET DOME 6 COBALT GREY	39651	44	500 X 500	17,9	42,8	231,9	250,8	10	19,1	204,1X202,6	3	✓
--	------------------------	-------	----	-----------	------	------	-------	-------	----	------	-------------	---	---

DOMEO 6 LOGGIA NEW

TEMPERED
GLASS

DOMEO



SPACIOUS AND LIGHT FILLED COSY CORNER CABIN WITH UNDERCOVER SEATING



DOMEO 6 LOGGIA

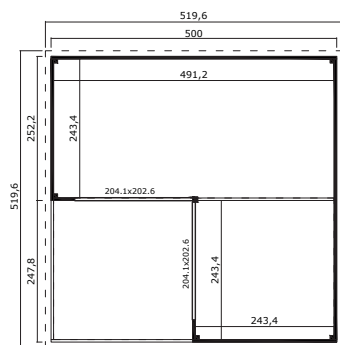

Domeo 6



DOMEO 6 LOGGIA	41302	44	500 X 500	17,9	58,45	250,8	250,8	80	26,26	204,1 X202,6	3	✓



CONTEMPORARY DESIGN WITH LARGE WINDOWS AND WITH 28 MM GLAZED DOORS, COVERED SEATING AREA FOR RAINY DAYS



DOME0 7



ALUMINIUM WINDOWS & DOORS AND METAL ROOF EDGE TRIMS

- Designed as double toughened glazed to optimise the use of larger glazing areas, so as not to compromise on structural weight bearing
- Modern, virtually maintenance-free, long lasting and exceptionally resistant to weather conditions



SET DOME0 7
COBALT GREY

41332

44

400 X 300

11,39

27,92

239,4

250

80

23,6

158,8 X 198

60 X 183,2
117 X 183,2

-

2

✓



CONTEMPORARY DESIGN WITH LARGE WINDOWS AND WITH 28 MM GLAZED BI-FOLD DOORS



DOMEO 8

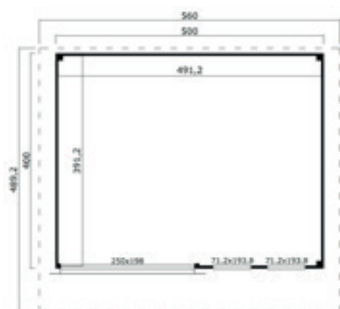

SET DOMEO 8
COBALT GREY

41337

44

500X400

19,22

46

239,4

239,4

80

26,9

250 X 198

60 X 183,2 X 2

-

3

✓



HIGHLY CONTEMPORARY CORNER DOOR DESIGN SUN ROOM METAL ROOF EDGE DETAIL WITH 28 MM GLAZING



DOMEO 9

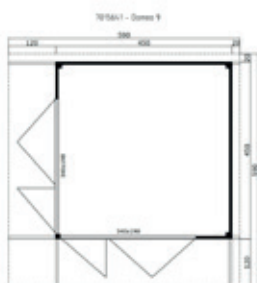

DOMEO 9 COBALT GREY

7015641

70

450 X 450

19

47,83

244,8

258,4

120

34,83

340 X 198

-

4

✓



HIGHLY CONTEMPORARY CORNER DOOR DESIGN SUN ROOM WITH LARGE UNDERCOVER SEATING AREA, METAL ROOF EDGE DETAIL WITH 28 MM GLAZING



DOMEO 10



DOMEO 10 COLBALT GREY

7015741

70

450 X 850

19*28

91,71

244,8

258,4

120

52,54

340 X 198

-

7

✓

INTERNAL ROOM KIT

INTERNAL ROOM KIT- PERFECT FOR USE AS A BATHROOM OR WARDROBE

OUR INTERNAL ROOM KITS

- ✓ Adapt your selected cabin with an internal room kit.
- ✓ Available in 2 sizes.
- ✓ Adds to 1-roomed cabin practical value with various functions (as a bathroom, wardrobe or storage).
- ✓ Perfect for sectional models, adaptable also with other garden buildings (consideration needs to be given to internal space and roof height).
- ✓ With a practical space-saving sliding door with nontransparent milky glazing.
- ✓ Upon functional need option to order extra window with suitable design.
- ✓ The room kit M can be adapted in length to fit the size of the room from 180 to 250 cm.

INTERNAL ROOM KIT S



INTERNAL ROOM KIT S

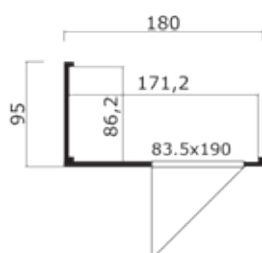

INTERNAL ROOM KIT M



INTERNAL ROOM KIT M

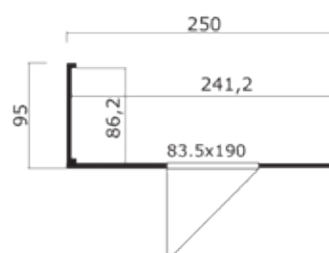

	Nº			m²	m³						
KIT S	9901300	44	180X95	1,59	3,26	205,2	205,2	-	1,71	83,5X190,0	-
KIT M	9901400	44	250X95	2,23	4,57	205,2	205,2	-	2,35	83,5X190,0	-

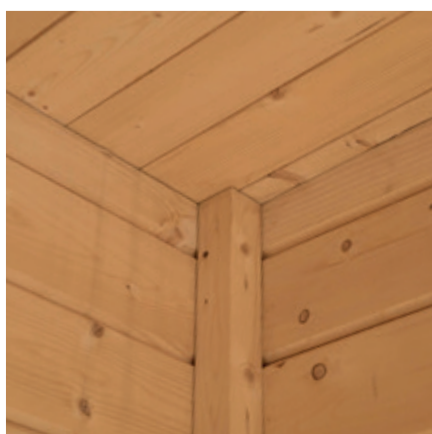

Modern corner connection



Aluminium sliding doors



Aluminium corner protection

HIDDEN ROOF BEAM BEARERS



TIP! For ultra-modern look upgrade your Domeo with hidden roof beam bearers as an additional kit.



Optional



Standard

OUR HOME OFFICES

Do you want to be creative or just need a place to work focused? Especially in corona times the new trend of protected working in your garden in a wooden home office is getting more and more important.

Your work succeeds if you can work undisturbed from your living space and really focus on your tasks and actions with the view into the outdoors. No unwanted disturbance from the family, no children asking what's for dinner or a partner who no longer knows where they left their car keys.

You can „escape“ all of this in your home office in the garden cabin and concentrate fully on your work and the possible deadlines. With our home office range the potential for your own office in the garden. The chosen cabins are equipped with insulated glazing and fits to your modern architecture. With our large windows you have enough daylight inside. Nothing increases the productivity more than natural daylight. Find endless options of space and design for your homework and enjoy our Lasita Maja home offices.





IDEAL HOME OFFICE CABIN EXTENDING YOUR INDOOR SPACE



DORSET 2

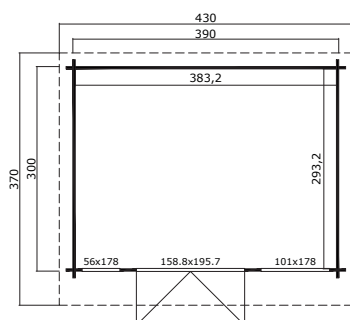

DORSET 3

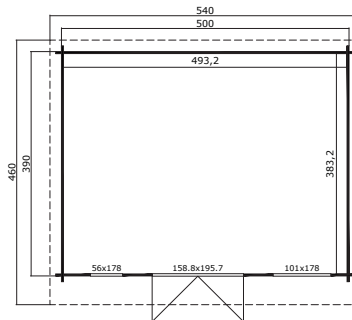

	Nº	Icon	Icon	m²	m³	Icon	Icon	Icon	Icon	Icon	Icon	Icon	Icon
DORSET 2	3419602	34	320X410	11,24	25,3	210,9	239,4	50	15,96	158.8X195.7	56X178/101X178	2	✓
DORSET 3	3419702	34	410X520	18,9	42,55	210,9	239,4	50	25,3	158.8X195.7	56X178/101X178	2	✓

SUSSEX 1

NEW

TEMPERED
GLASS

GOLD



POPULAR BI-FOLD DOORS HAVE BEEN INCLUDED ALLOWING YOU TO OPEN UP YOUR GARDEN FOR THOSE WORK DAYS

SUSSEX 2

NEW

TEMPERED
GLASS

GOLD



POPULAR BI-FOLD DOORS HAVE BEEN INCLUDED ALLOWING YOU TO OPEN UP YOUR GARDEN FOR THOSE WORK DAYS

SUSSEX 1

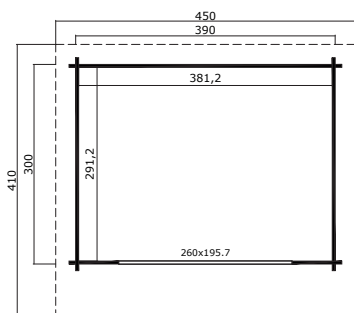

SUSSEX 2

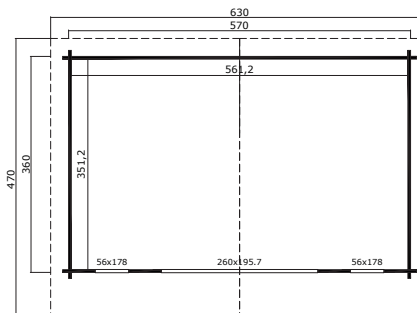

	Nº			m²	m³								
SUSSEX 1	41307	44	390X300	11,1	26,26	233,7	210,9	80	18,38	260X195,7	-	3X10	✓
SUSSEX 2	41312	44	570X360	19,71	44,38	233,7	210,9	80	30,01	260X195,7	-	3X15	✓



DOUBLE DOORS OPEN OUT WITH TWO LARGE WINDOWS CREATING A LIGHT & AIRY SPACE TO WORK IN



DORSET 71

DORSET 72

DORSET 73

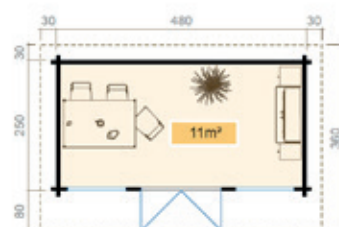
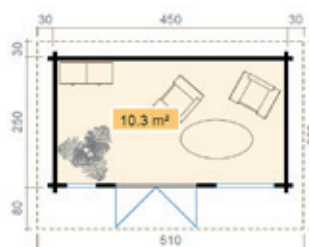
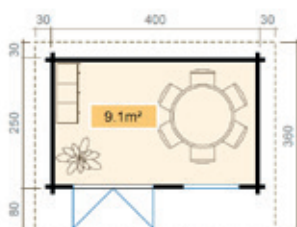

	Nº			m²	m³									
DORSET 71	709502	70	250 X 400	9,11	20,75	221,3	234,9	80	16,62	158 X 193,3	110 X 172,9	-	4	✓
DORSET 72	709602	70	250 X 450	10,29	23,79	224,4	238	80	18,43	158 X 193,3	110 X 172,9 55,2 X 172,9	-	4	✓
DORSET 73	709702	70	250 X 480	11	25,43	224,4	238	80	19,51	158 X 193,3	110 X 172,9 X2	-	4	✓



\ **DOMEO 3** page **16**



\ **DOMEO 9** page **26**

Modern, clear and focused – this is our updated Domeo series. Glass and Aluminum in combination with wood and functional designs brings tons of options as a home office in your garden.

Check out page 10 till 29



\ **DOMEO 6** page **22**



\ **DOMEO 3** page **16**

Also check out
our **Domeo**
series

HOME OFFICE



\ **DOMEO 4** page **18**

DOMEO SERIES

Perfect as
home office



\ **DOMEO 2** page **15**

Here your
wishes
become reality!



OUR GARDEN BUILDINGS

We are specialists of garden and leisure buildings. On the following pages you will find our extensive range of garden buildings.

Regardless of the purpose you want to use the garden building for, here you will find a broad range for you to choose from. From tool sheds from 18 mm wall thickness and our

garden houses starting at 28 mm and leisure houses from 44 mm. Numerous shapes, with gabled roofs, stepped roofs, pent roofs or flat roofs, the classic models with a terrace or buildings with several rooms – you will find a model for every purpose. Enjoy the diversity and search our product range at your leisure.

With large porch and practical fully wooden door. Window is mountable on the left or right side.

EXTEND CORTINA CABIN WITH OPTIONAL ACCESSORIES IN TRADITIONAL CHALET-STYLE AS TERRACE, WINDOW SHUTTERS AND FLOWER BOXES.



Optional flowerbox, art. 990700



Optional terrace, art. 4022000

CORTINA

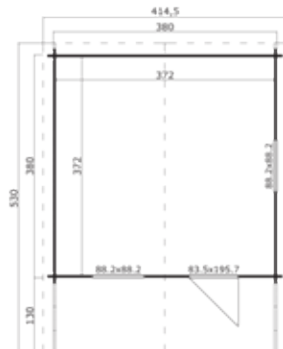

CORTINA WITH TERRACE



Optional shutters, art. 994700



CORTINA	4021700	40	380X380	13,84	-	205,2	256,5	130	22,79	83,5X195,7	88,2X88,2	✓	3	9
---------	---------	----	---------	-------	---	-------	-------	-----	-------	------------	-----------	---	---	---

NORDERNEY 3

TEMPERED
GLASS

SILVER



Side window mountable on the left or right side. With a large overhang.

Optional mirroring

AVAILABLE IN 2 SIZES



	Nº	Icon	Icon	m²	m²	Icon	Icon	Icon	Icon	Icon	Icon	Icon	Icon	Icon	Icon
NORDERNEY 2	401900	40	390 X 300	11,2	25,7	205	257	●	70	17,9	149,4 X 195,7	129 X 99	✓	● 2	● 7
NORDERNEY 3	402000	40	390 X 390	14,6	33,7	205	257	●	70	22,1	149,4 X 195,7	129 X 99	✓	● 2	● 9



NORDERNEY 2

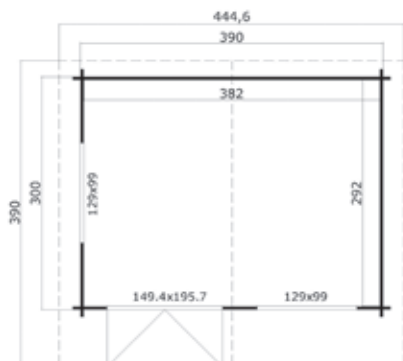

NORDERNEY 3

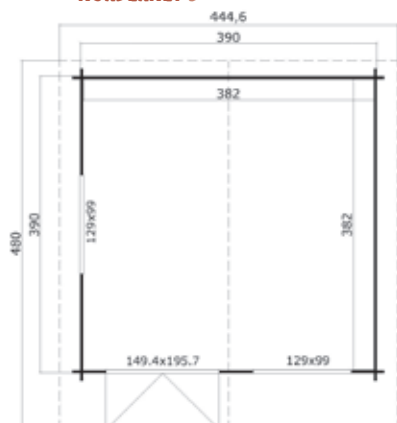



Includes a double window in the side wall and a large porch.



Borkum assembly
video

CREATE SPACE IN YOUR GARDEN!

Our Borkum series impresses with its division into two rooms.

The main room is equipped with a spacious double door with a light cut-out.

The storage room – with a massive solid wood door – is perfect for the storage of your garden tools or other utensils.

- ✓ The Borkum model is equipped with 2 rooms and allows plenty of storage space for your gardening tools.
- ✓ With 2 rooms
- ✓ Available in 4 sizes

BORKUM 2



BORKUM 5

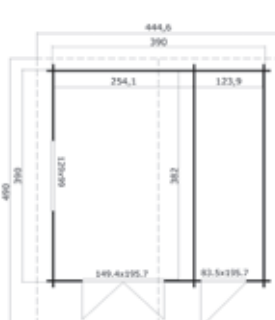

Our two-room wonder!



	Nº	40	390 X 300	11,2	25,7	205	257	80	18,4	149,4 X 195,7 / 83,5 X 195,7	129 X 99	✓	2	7
		40	390 X 390	14,6	33,7	205	257	80	22,5	149,4 X 195,7 / 83,5 X 195,7	129 X 99	✓	2	9

BORKUM 4

TEMPERED
GLASS

SILVER

GARDEN BUILDINGS

Optional mirroring



BORKUM 4

BORKUM 6

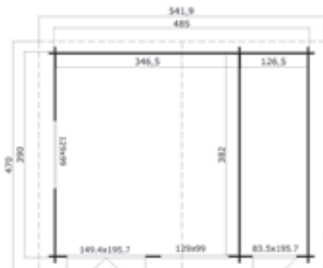
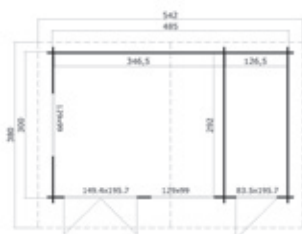

	Nº			m²	m²									
BORKUM 4	401700	40	485 X 300	13,9	32,9	205	268	60	21,3	149,4 X 195,7 / 83,5 X 195,7	129 X 99	✓	3	8
BORKUM 6	406200	40	485 X 390	18,2	43,1	205	268	60	26,3	149,4 X 195,7 / 83,5 X 195,7	129 X 99	✓	4	10

EDINBURGH 2

TEMPERED
GLASS

GOLD



With a space-saving corner entrance.

EDINBURGH 2

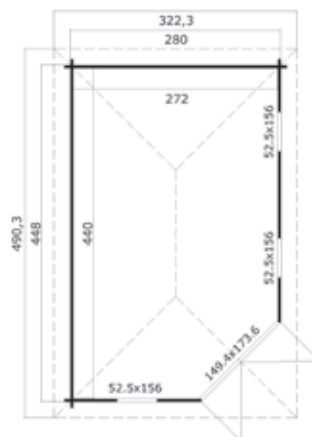

Nº



EDINBURGH 2

407640

40

280 X 448

12

26

205

246

21.1

16.4

149,4 X 173,6

52,5 X 156

✓

2

8



With a space-saving corner entrance.



ARUBA 1

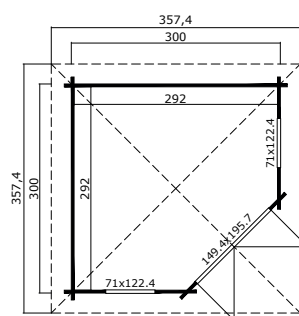

ARUBA 1	4014400	40	300 X 300	7.6	17.8	217	266	●	29	13.4	149.4 X 195.7	71 X 122.4	✓	● 2	● 7



With a space-saving corner entrance and with two rooms.

ARUBA 2B

TEMPERED
GLASS

SILVER



ARUBA 2A

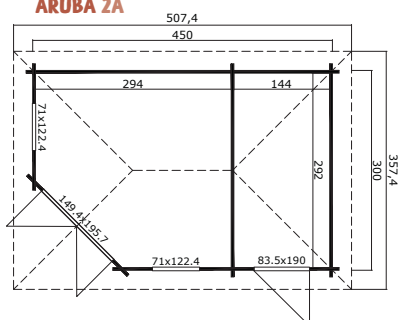

ARUBA 2B

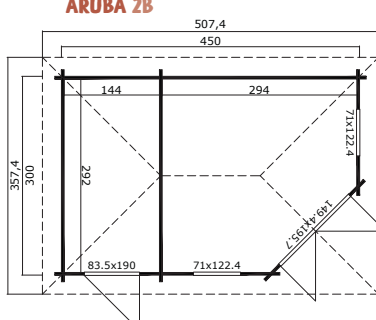

ARUBA 2A	4014500	40	450 X 300	12	29	217	266	☉	29	19	83,5 X 190 / 149,4 X 195,7	71 X 122,4	✓	☉ 2	☉ 10
ARUBA 2B	4014510	40	450 X 300	12	29	217	266	☉	29	19	149,4 X 195,7 / 83,5 X 190	71 X 122,4	✓	☉ 2	☉ 10

ARUBA 3A

TEMPERED
GLASS

SILVER

GARDEN BUILDINGS

With a space-saving corner entrance and with two rooms.



TEMPERED
GLASS

SILVER

ARUBA 3A

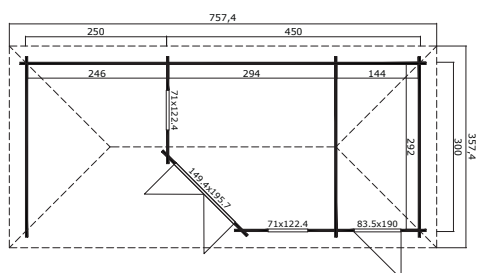

ARUBA 3B

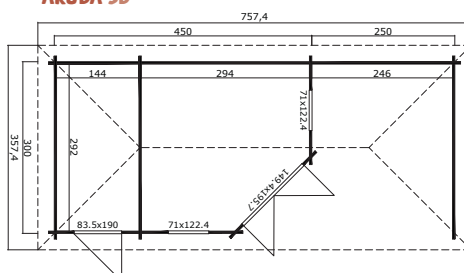

	Nº	40	450 X 300	20,2	48,7	217	266	278	28,3	83,5 X 190 / 149,4 X 195,7	71 X 122,4	✓	4	15
ARUBA 3A	4014600	40	450 X 300	20,2	48,7	217	266	278	28,3	83,5 X 190 / 149,4 X 195,7	71 X 122,4	✓	4	15
ARUBA 3B	4014610	40	450 X 300	20,2	48,7	217	266	278	28,3	83,5 X 190 / 149,4 X 195,7	71 X 122,4	✓	4	15

GOTLAND

TEMPERED
GLASS

SILVER

GOTLAND 7F



Optional mirroring

- ✓ Gotland series stands out due to its many variations
- ✓ Includes two double windows (only Gotland 7)
- ✓ Garden house in 40 mm wall thickness
- ✓ Available in 4 sizes

Choose from
a variety
of options!

	Nº	Icon	Icon	m²	m²	Icon	Icon	Icon	Icon	Icon	Icon	Icon	Icon	Icon	Icon	Icon
GOTLAND 3E	4015300	40	390 X 300	11,1	25,6	205	257	●	150	21,5	158,8 X 195,7	88,2 X 88,2	✓	● 2	● 9	●
GOTLAND 5E	4016200	40	390 X 390	14,5	33,7	205	257	●	150	25,8	158,8 X 195,7	88,2 X 88,2	✓	● 3	● 10	●
GOTLAND 6F	4016000	40	485 X 390	18,2	44	205	279	●	120	29,7	158,8 X 195,7	129 X 88,2	✓	● 4	● 11	●
GOTLAND 7F	4016100	40	485 X 485	22,7	57,7	217	291	●	50	31,0	158,8 X 195,7	2 X 129 X 88,2	✓	● 4	● 12	●



With a large overhang and glazed door ensures plenty of light.



TIP! Extend your cabin with suitable terrace, roof extension or other accessories from our selection (page 121).

GOTLAND 3E

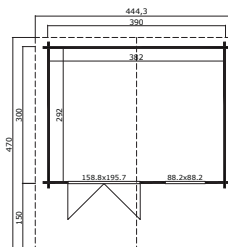

GOTLAND 5E

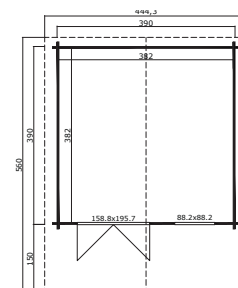

GOTLAND 6F

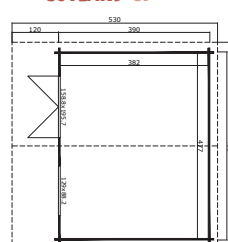

GOTLAND 7F

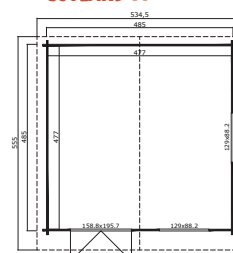















OBAN 40



With a space-saving corner entrance.



<div><div></div><div></div><div></div><div></div><div></div><div></div><div></div><div></div><div></div><div></div><div></div><div></div><div></div><div></div></div>														
OBAN 40	408940	40	240 X 240	4,8	10,5	205	241	21,3	8,3	149,4 X 173,6	52,5 X 156	✓	1	5

Practical corner
entrance saves
space!



OBAN 40

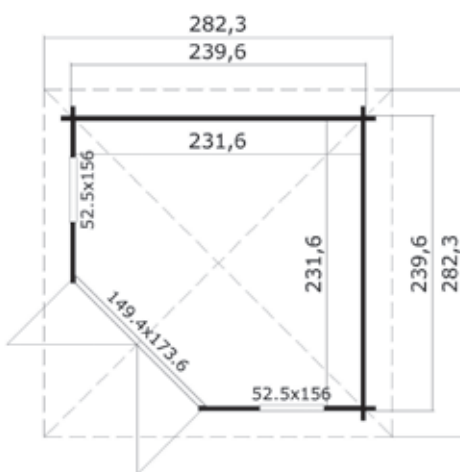

Pictures show design examples

Fixed double window, plenty of glass on front side ensures good lighting.



DORSET

348902

34

390 X 250

9,3

20,7

211

234

50

13,8

158,8 X 195,7

56 X 178 / 101 X 178

✓

2

TEMPERED
GLASS

GOLD



Modern design
with plenty
of light!

GARDEN BUILDINGS



DORSET

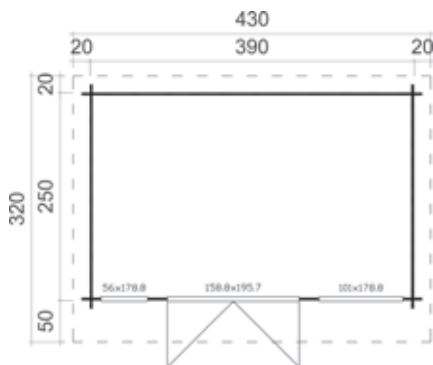



Optional mirroring



CARLISLE

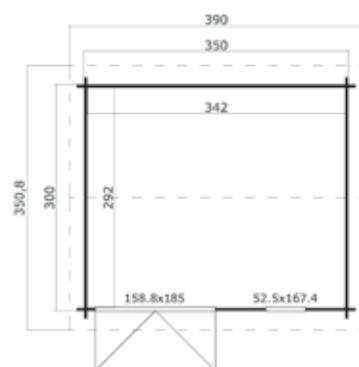

CARLISLE

405602

40

350 X 300

10

22,8

211

245

25,4

14

158,8 X 185

52,5 X 167,4

✓

• 2

• 6



Pent roof model with large glass panels.



Extension kit for a storage room- perfect with our Barbados range and with many other pent roof models. Extensions are available in 2 sizes.

BARBADOS MINI

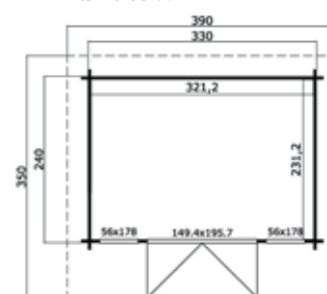



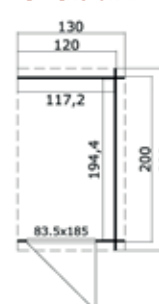



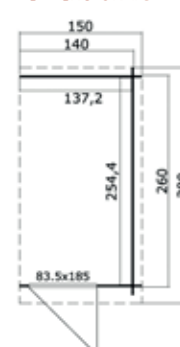







EXTENSION 200



EXTENSION 260



															
BARBADOS MINI	4415040	44	330 X 240	7,4	16,5	208	231	-	80	13,7	149,4 X 195,7	56 X 178	✓	2	2
EXTENSION 200	2829200	28	120 X 200	2,22	4,44	188	211	-	10	2,88	83,5 X 185	-	-	1	2
EXTENSION 260	2829600	28	140 X 260	3,42	6,82	188	211	-	10	4,37	83,5 X 185	-	-	1	3

BARBADOS 5

TEMPERED
GLASS

PLATINUM

Pent roof model
with up to 70 mm
wall thickness.

Optional mirroring

BARBADOS 6

TEMPERED
GLASS

GOLD

Optional mirroring

BARBADOS 2

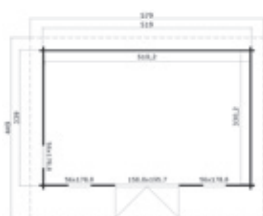

BARBADOS 3

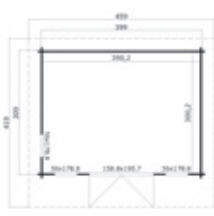

BARBADOS 4

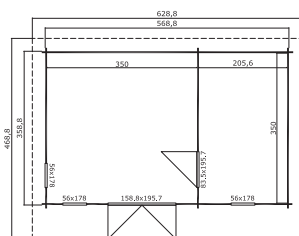

BARBADOS 5



BARBADOS 6

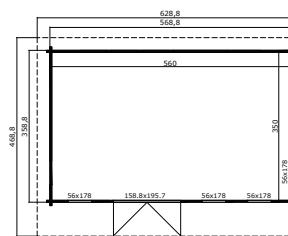

№



BARBADOS 2	4414502	44	519 X 339	16,9	37,5	211	234	⊙	80	26,1	158,8 X 195,7	56 X 178	-	✓	⊙ 3
BARBADOS 3	4414602	44	399 X 309	11,7	26	211	234	⊙	80	19,3	158,8 X 195,7	56 X 178	-	✓	⊙ 2
BARBADOS 4	446602	44	569 X 359	19,6	43,6	211	234	⊙	80	29,5	158,8 X 195,7 / 83,5 X 195,7	56 X 178	-	✓	⊙ 3
BARBADOS 5	7010702	70	519 X 399	19,4	46,3	211	238	⊙	80	33,5	158 X 193,3	55,2 X 172,9	-	✓	⊙ 5
BARBADOS 6	4423902	44	359 X 569	19,62	43,61	210,9	233,7	⊙	30	29,54	158,8 X 195,7	-	56,0 X 178,0	✓	⊙ 3

JAVA

TEMPERED
GLASS

GOLD

GARDEN BUILDINGS

Large sliding door for more natural light. Included roof trims in Zinc-coated.

Optional mirroring

JAPAN

TEMPERED
GLASS

GOLD

Modern, light design with standard exterior doors, optional positioning of 2 interior doors.

JAVA

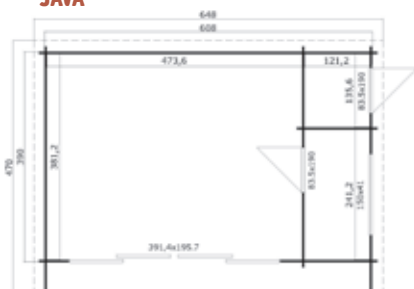

JAPAN



JAVA	4415802	44	608 X 390	22,8	53,4	222	245	60	30,5	391,4 X 195,7	83,5 X 190	150 X 41		✓	⦿ 3	⦿ 12
JAPAN	4424702	44	608 X 390	22,84	53,4	222	245	60	30,52	158,8 X 195,7	83,5 X 190	-	560 X 1780 1010 X 1780	✓	⦿ 3	⦿ 12

DOMINICA



A modern design with plenty of natural light, with a wide terrace and 2 entrances

DOMINICA

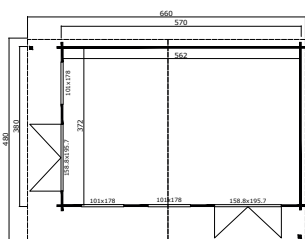

	Nº	40	570 X 380	20,91	50,05	234	245	80	31,68	158.8 X 195.7	101 X 178	-	3	✓
DOMINICA	4019999													



BRIGHTON 44

With an opening and non-opening window. Includes an impregnated terrace and a side-louvre.

BRIGHTON 44

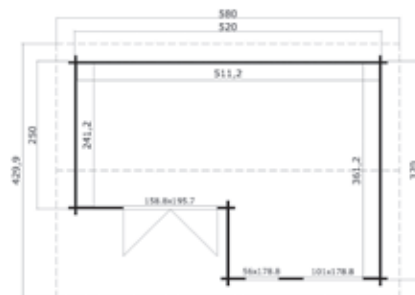

HAMPSHIRE

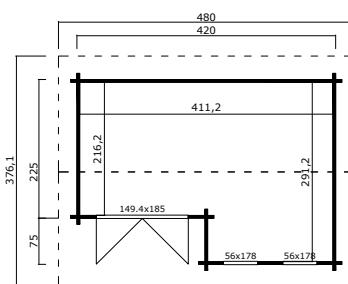

Assembly video

CHOOSE BETWEEN 2 MODERN CABINS
WITH SIMILAR LOOK IN DIFFERENT SIZES

	No	Icon	Area	Volume	Weight	Length	Width	Height	Depth	Weight	Weight	Weight	Weight	Weight
BRIGHTON 44	4416902	44	520 X 370	18,5	42,6	211	251	30	25,5	158,8 X 195,7	56 X 178 / 101 X 178	✓	3	8
HAMPSHIRE	4423202	44	420 X 300	10,41	26,62	222,3	239,4	30	18,72	149,4 X 185,0	2 X 56 X 178	✓	2	8



Optional mirroring

HAMPSHIRE



Includes an
impregnated terrace
and a side-louvre
entrance.

Optional mirroring



Nº



ORKNEY

4413802

44

520 X 390

19,5

44,4

222

234

30

26,1

158,8 X 195,7

-

56 X 178

✓

3

-



Includes an impregnated terrace and a side-louvre with a spacious roof.

Optional mirroring



TORQUAY



TORQUAY	4417502	44	575 X 370	20,5	47,2	217	245	32	27,1	158,8 X 195,7	-	56 X 178 / 101 X 178	-	✓	4	11
---------	---------	----	-----------	------	------	-----	-----	----	------	---------------	---	----------------------	---	---	---	----



Garden house
with 3 rooms and an
additional floor.
Perfect as a
homeoffice/
weekendcabin



Design example



Design example

Plenty of room – many possibilities

Our Caroline is perfect for your weekend outdoors or as a home office. It is equipped with three rooms. The integrated additional floor can be used as a storage or a sleeping area. It can be accessed through stairs.

Caroline includes additional single door, which position can be chosen during assembly. Therefore you can adapt this garden house exactly to your needs.



CAROLINE 1

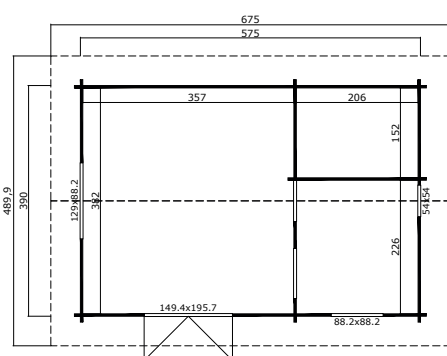

CAROLINE 1 / LOFTPLAN

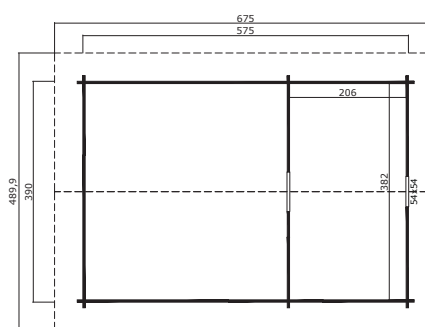

Design example

EXTRA OPTION: CAROLINE WITH TERRACE

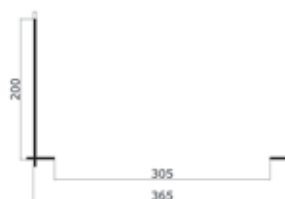
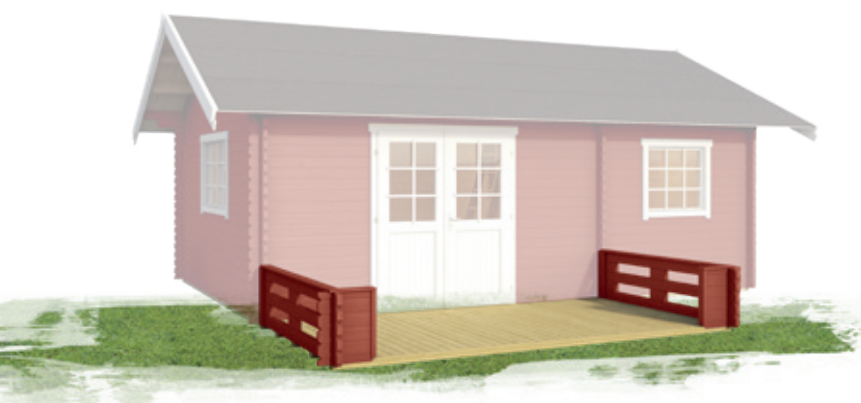

Optional door and window quality:
just choose your preference!

	Nº			m²	m³										
CAROLINE 1 SET SILVER	39372	40	575 X 390	21,7	61,1	234	331	50	37,1	83,5 X 190 / 149,4 X 195,7	88,2 X 88,2	54 X 54	✓	4	14
CAROLINE 1 SET GOLD	39544	40	575 X 390	21,7	61,1	234	331	50	37,1	83,5 X 190 / 149,4 X 195,7	88,2 X 88,2	54 X 54	✓	4	14
TERRACE	4019400	40	190 X 385	6,86											



A stylish 3 roomed cabin, plenty of space for multiple uses. Leisure, work, gives you additional space without costing a lot.



CAROLINE 2.1

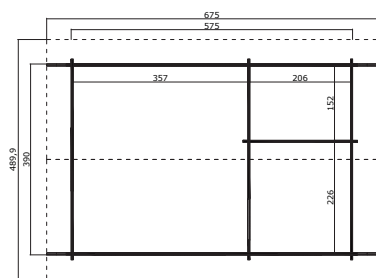

CAROLINE 2.1 / LOFTPLAN

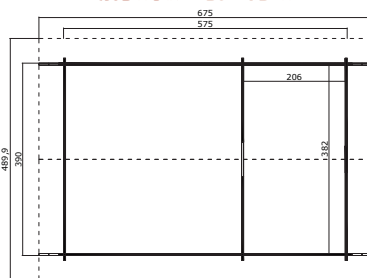

Style your own cabin. It comes to you as a base cabin, without the doors and windows cut in. You then choose from 3 style options, and from these you can decide the location of the doors and windows.

	Nº	Icon	Icon	m²	m²	Icon	Icon	Icon	Icon	Icon	Icon	Icon	Icon	Icon
CAROLINE 2.1	41317	40	390 X 575	21.66	61.73	239,4	330,6	50	37,12	265,8 X 195,7 835 X 190	129 X 882,2 88,2 X 88,2 54 X 54	4	14	✓



A stylish 3 roomed cabin, plenty of space for multiple uses. Leisure, work, gives you additional space without costing a lot.



CAROLINE 2.2

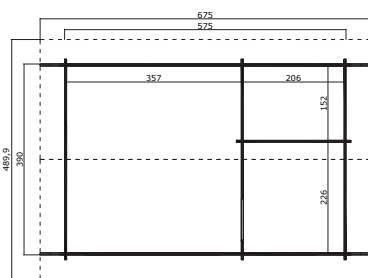

CAROLINE 2.2 / LOFTPLAN

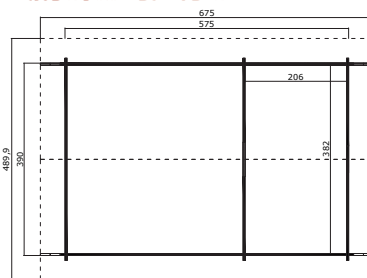

Style your own cabin. It comes to you as a base cabin, without the doors and windows cut in. You then choose from 3 style options, and from these you can decide the location of the doors and windows.



CAROLINE 2.2	41322	40	390 X 575	21,66	61,73	239,4	330,6	50	37,12	265,8 X 195,7 835 X 190	129 X 882.2 88.2 X 88.2 54 X 54 / 150 X 51	4	14	✓
--------------	-------	----	-----------	-------	-------	-------	-------	----	-------	----------------------------	--	---	----	---

CAROLINE 2.3 NEW



CAROLINE 2.3

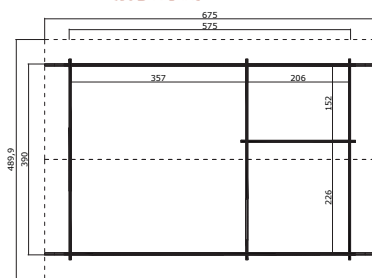

CAROLINE 2.3 / LOFTPLAN

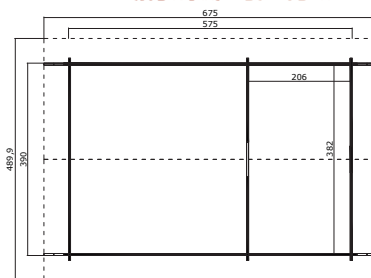

№



CAROLINE 2.3	41327	40	390 X 575	21.66	61.73	239,4	330,6	50	37,12	260 X 195,7 835 X 190	129 X 882.2 88.2 X 88.2 54 X 54 /150 X 51	4	14	✓
--------------	-------	----	-----------	-------	-------	-------	-------	----	-------	--------------------------	---	---	----	---



Style your own cabin. It comes to you as a base cabin, without the doors and windows cut in. You then choose from 3 style options, and from these you can decide the location of the doors and windows.

BERKSHIRE 43

TEMPERED
GLASS

GOLD



Includes a porch entrance.

Optional mirroring

BERKSHIRE 53

TEMPERED
GLASS

GOLD



Includes a porch entrance.

Optional mirroring

BERKSHIRE 43

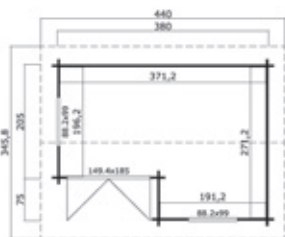

BERKSHIRE 53

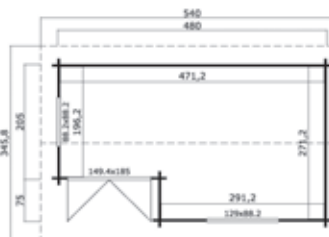

OPTIONAL SIDE LOUVRE



BERKSHIRE 43	4413340	44	380 X 280	10	22	200	240	33	15,84	149,4 X 185	88,2 X 99	✓	2	7
BERKSHIRE 53	4414840	44	480 X 280	12,8	28	200	240	33	19,44	149,4 X 185	88,2 X 88,2 / 129 X 88	✓	2	8
OPTIONAL SIDE LOUVRE	991100													

DEVONSHIRE 43

TEMPERED
GLASS

GOLD



Optional mirroring



DEVONSHIRE 43

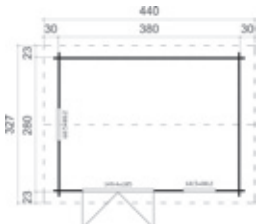

Nº



DEVONSHIRE 43

4413140

44

380 X 280

10,1

22,1

200

239

23,3

15

149,4 X 185

68,5 X 88,2

✓

2

6



Optional positioning
of the interior door.

ALEXANDRA

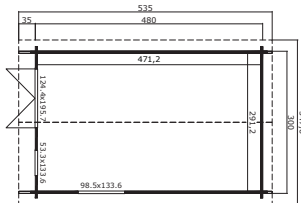

BRISTOL

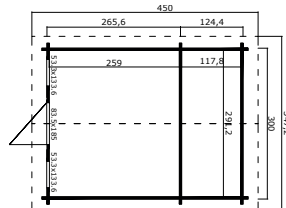

ALEXANDRA	4422740	44	300 X 480	13,7	31	205	245	35	19,3	124,4 X 195,7	53,3 X 133,6	98,5 X 133,6	✓	⦿ 2	⦿ 8	
BRISTOL	4423502	44	300 X 390	11,1	24,99	205	245	30	16,2	2 PCS 83,5 X 185	-	533 X 133,6	✓	⦿ 2	⦿ 7	

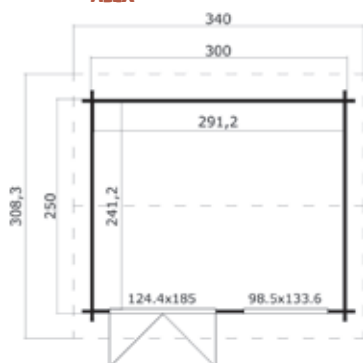

A perfect cabin for a small garden !

ALEX	4414440	44	300 X 250	7	16	211	245	29,1	10,9	124,4 X 185	98,5 X 133,6	✓	⦿ 1	⦿ 5



Optional mirroring



ALEX MINI

TEMPERED
GLASS

GOLD



Optional mirroring

ELGIN 44

TEMPERED
GLASS

GOLD

SILVER



Optional mirroring

ALEX MINI

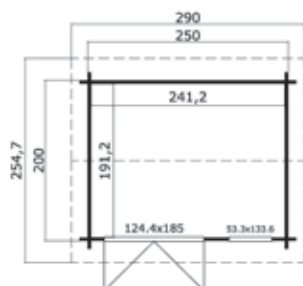

ELGIN 44

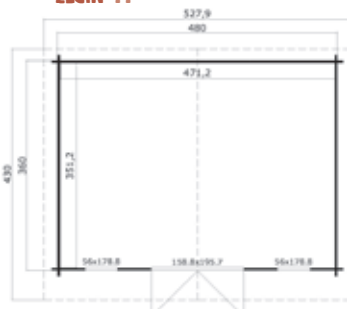
**NEW!**

Optional door and window quality of Elgin 44: just choose your preference!

Nº



ALEX MINI	4416540	44	250 X 200	4,61	10,5	211	245	27	7,8	124,4 X 185	53,3 X 133,6	✓	1	4
ELGIN 44 SET SILVER	39631	44	480 X 360	16,6	40,1	217	268	50	23,2	158,8 X 195,7	56 X 178	✓	2	9
ELGIN 44 SET GOLD	39636	44	480 X 360	16,6	40,1	217	268	50	23,2	158,8 X 195,7	56 X 178	✓	2	9

JUBILEE 44

TEMPERED
GLASS

GOLD

GARDEN BUILDINGS



TEMPERED
GLASS

GOLD

JUBILEE 44

BARUDA 53

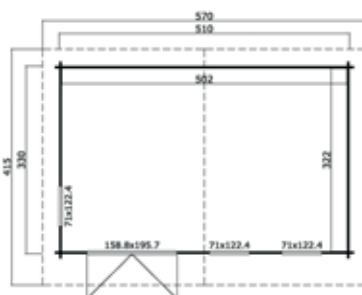
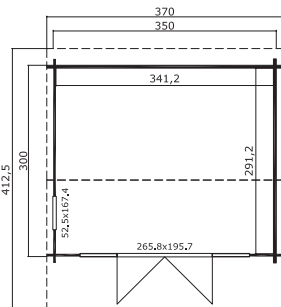

Nº



JUBILEE 44	4411202	44	300 X 350	9,94	23,22	222,3	245,1	10	15,54	265,8 X 195,7	52,5 X 167,4	✓	⊙ 2	⊙ 6
BARUDA 53	407999	40	510 X 330	16,2	34	200	222	55	23,8	158,8 X 195,7	3 X 71 X 122,4	✓	⊙ 3	-

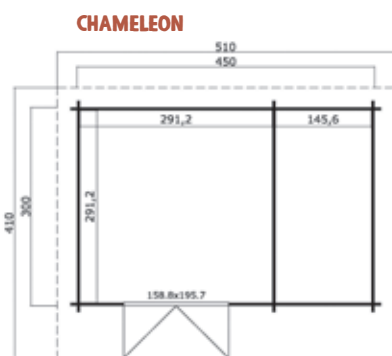

Adaptable
according
to your needs!

CHAMELEON	4420002	44	450 X 300	12,8	29,3	222	234	80	20,93	158,8 X 195,7 / 83,5 X 195			56 X 178	✓	3

PORTSMOUTH 44

TEMPERED
GLASS

GOLD

GARDEN BUILDINGS



Optional positioning of the double door and double window.



PORTSMOUTH 44

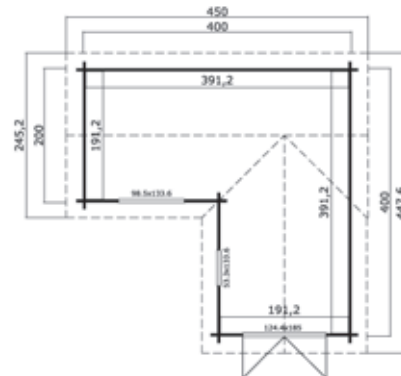

PORTSMOUTH 44

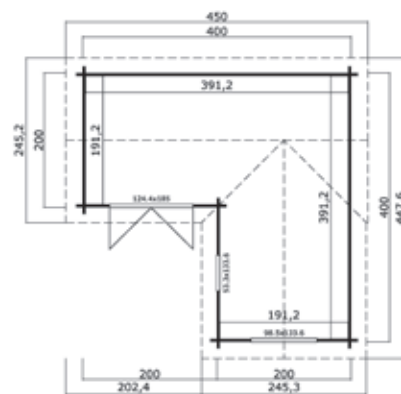

PORTSMOUTH 44	4420102	44	400 X 400	11,3	25,76	211	245	25	19,4	124,4 X 185	53,3 X 133,6 / 98,5 X 133,6	✓	2	8
---------------	---------	----	-----------	------	-------	-----	-----	----	------	-------------	-----------------------------	---	---	---

VICTORIAN



KENSINGTON

TEMPERED
GLASS

GOLD

VICTORIAN STYLE



PEMBROKESHIRE 53

TEMPERED
GLASS

GOLD



KENSINGTON

PEMBROKESHIRE 53

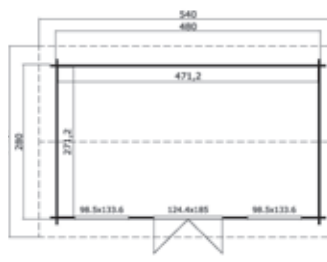
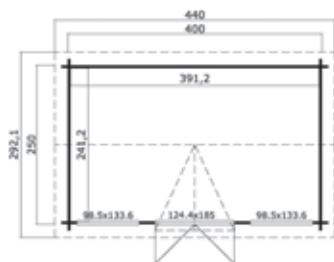

KENSINGTON	4414340	44	400 X 250	9,44	20,71	200	240	21	14,24	124,4 X 185	98,5 X 133,6	-	✓	2	7
PEMBROKESHIRE 53	4414740	44	480 X 280	12,8	28,1	200	240	33	19,44	124,4 X 185	98,5 X 133,6	-	✓	2	9



Includes a porch entrance.

Optional mirroring



SRI LANKA



Optional door and window quality:
just choose your preference!

	Nº														
--	----	--	--	--	--	--	--	--	--	--	--	--	--	--	--

SRI LANKA SET SILVER	39641	44	560 X 480	26	62,9	222	285	21,1	32,4	158 X 195,7	71 X 122,4	✓	3	13
SRI LANKA SET GOLD	39646	44	560 X 480	26	62,9	222	285	21,1	32,4	158 X 195,7	71 X 122,4	✓	3	13

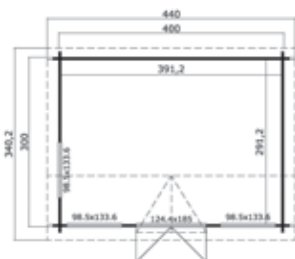

WINDSOR 44	4415240	44	400 X 300	11,4	25,7	211	240	24	16,3	124,4 X 185	-	98,5 X 133,6	✓	⦿ 2	⦿ 8
------------	---------	----	-----------	------	------	-----	-----	----	------	-------------	---	--------------	---	-----	-----

GARAGES WITH SPACE

You need more space in your home? No problem! With our garages you have a perfect shelter for your car, your motorbike or the right place for your workshop. Garages are delivered without a floor.

Depending on your needs, these models can be delivered with or without doors. There are two garage door options available: wooden garage doors or Hörmann-steel framed up and over doors.



Make your
wishes
come true!

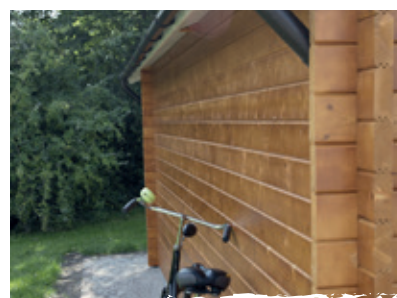

All pictures show design examples



Includes a storage room with a solid wooden door. Stepped roof with 3 vertical skylights.

Optional mirroring kit available

ALL GARAGES ARE AVAILABLE WITHOUT A DOOR, WITH A WOODEN DOOR OR STEEL FRAMED WOODEN UP-AND-OVER GARAGE DOORS



HAWAII

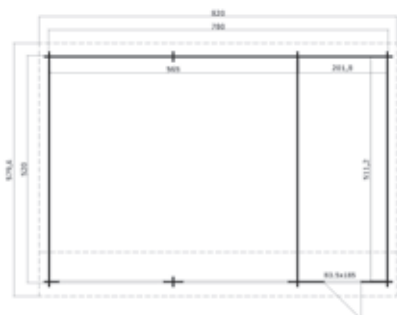

Modern design combined with functionality!

Nº														
HAWAII	4410693	44	780 X 520	39,4	103,2	228	322	31,2	51,7	83,5 X 185	150 X 41	✓	8	19

Optional mirroring

ALL GARAGES ARE AVAILABLE WITHOUT A DOOR, WITH A WOODEN DOOR
OR STEEL FRAMED WOODEN UP-AND-OVER GARAGE DOORS



CANBERRA

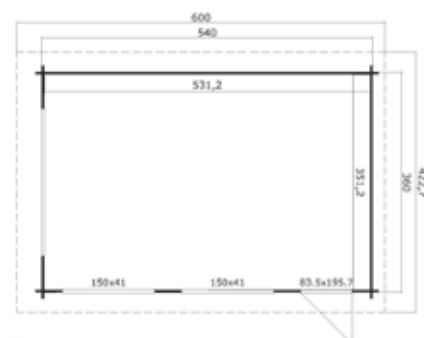

													
CANBERRA	4412193	44	360 X 540	18,7	42,5	222	234	40	24,9	83,5 X 195,7	150 X 41	✓	4



A double window and a service door can be installed individually.

Possibility of roof assembly in 2 directions.

ALL GARAGES ARE AVAILABLE WITHOUT A DOOR, WITH A WOODEN DOOR OR STEEL FRAMED WOODEN UP-AND-OVER GARAGE DOORS



With an optional storage kit





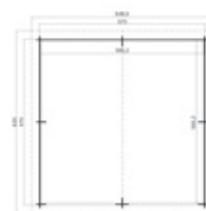
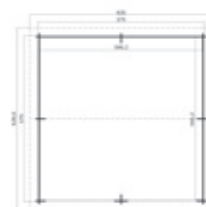



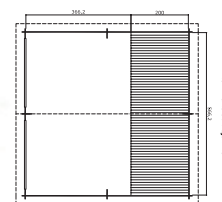









FALKLAND



STORAGE KIT



														
FALKLAND	4414193	44	575 X 575	32,1	85,9	222	314		30	41,9	83,5 X 195,7	129 X 88,2	 4	 16
STORAGE KIT	4419600	—	566 X 200	11,3	—	—	—	—	—	—	—	—	—	—



Porch entrance area.



NEVIS

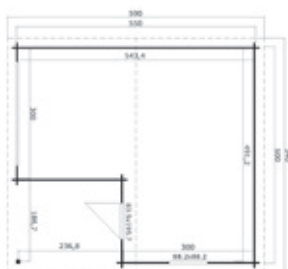

ALL GARAGES ARE AVAILABLE WITHOUT A DOOR, WITH A WOODEN DOOR OR STEEL FRAMED WOODEN UP-AND-OVER GARAGE DOORS



NEVIS	445193	44	500 X 550	22	55,7	205	302	✓	20	34,2	83,5 X 195,7	88,2 X 88,2	—	3	13
-------	--------	----	-----------	----	------	-----	-----	---	----	------	--------------	-------------	---	---	----

PAVILIONS





The favourite place
in your garden!

PAVILIONS



High-quality door fittings



Solid door hinges



Glazed doors and windows



Prefabricated roof elements



Secure cylinder lock

All pictures show design examples

2 windows
open outward,
3 windows fixed.



ILMENAU

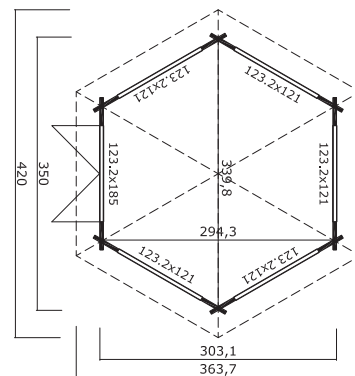

Nº



ILMENAU	442300	44	350 X 303	7,5	18,2	211	307	30	13,6	123,2 X 185	123,2 X 121	✓	2	8
---------	--------	----	-----------	-----	------	-----	-----	----	------	-------------	-------------	---	---	---

INVERNESS

TEMPERED
GLASS

GOLD

PAVILIONS

With two floor-to-ceiling windows, windows can be installed to your individual wishes.

RIVERA

TEMPERED
GLASS

GOLD

With 2 windows, which can be installed to your individual wishes.

INVERNESS

RIVERA

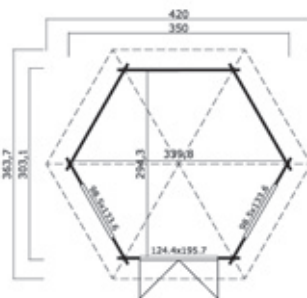

INVERNESS	4416002	44	280 X 242	4,73	11,2	211	289	17	7,78	83,5 X 185	71 X 167,4	✓	1	4
RIVERA	4416802	44	350 X 303	7,5	20,1	228	318	30	13,23	122,4 X 195,7	98,5 X 133,6	✓	2	8

The hexagonal pavilion is bright and airy, 3 windows open outward, 4 windows fixed.

JAMAICA

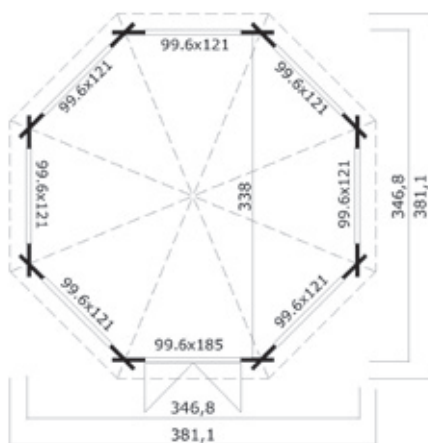

JAMAICA	442400	44	347 X 347	9,5	24	217	345	21	15,2	99,6 X 185	99,6 X 121	✓	2	9
---------	--------	----	-----------	-----	----	-----	-----	----	------	------------	------------	---	---	---



picture shown is design example!

OUR HOLIDAY HOUSES

You want to enjoy your free time in the outdoors and take a break from everyday life? Our wide range of holiday homes (in 70 and 92 mm wall thickness) offers a solution for every need. Whether you choose a preconfigured model from our catalogue or a bespoke holiday home in accordance with your wishes, almost anything is possible. Of course, all holiday homes can

be designed to your personal needs and requirements. Size, shape and look– all can be fitted to your taste. You decide layout and design and we will take care of the rest. We gladly take up the journey with you from the planning stage to the realisation of your holiday home and help you realise your dream. Just some examples, all is possible!

The holiday houses can be custom adjusted and designed to your wishes. Just contact us!

All holiday homes are available optionally with windows and doors in the quality Platinum, Diamond+ or Diamond ++.

A modern pent roof weekend house with a sliding door, with large light filled vestibule and a loft for use as a sleeping room.



MALMÖ

MALMÖ WITH TERRACE

MALMÖ SECOND FLOOR



TIP! Extend your log cabin with an optional terrace and roof extension.

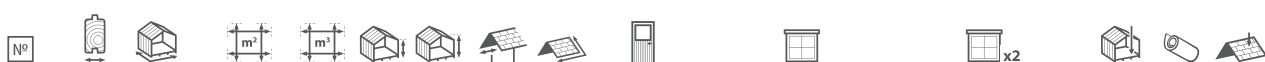

MALMÖ	7015041	70	500 X 600	28 + 11.8	100,7	272	480,6	40	37,8	250 X 200 82,7 X 200	159,5 X 172,9 / 250 X 78 159,5 X 78	110 X 172,9 / 150 X 51 245,5 X 128,4	✓	4	14
ROOF EXTENSION	9902500	-	270 X 586	15,8	-	-	-	-	16,6	-	-	-	-	2	7
TERRACE	9902400	-	260 X 600	15,6	-	-	-	-	-	-	-	-	✓	-	-



A modern weekend house with a light filled vestibule and a loft for use as a sleeping room.

ÖREBRÖ



ÖREBRÖ SECOND FLOOR



TIP! Extend your log cabin with an optional terrace.

	Nº	70	500 X 600	28 x 11.8	101,4	2584	4664	600	51,3	158 X 193,3	82,7 X 193,3	159,5 X 172,9	159,5 X 144,8	91,6 X 91,6	✓	5	19
ÖREBRÖ	7014941	70	500 X 600	28 x 11.8	101,4	2584	4664	600	51,3	158 X 193,3	82,7 X 193,3	159,5 X 172,9	159,5 X 144,8	91,6 X 91,6	✓	5	19

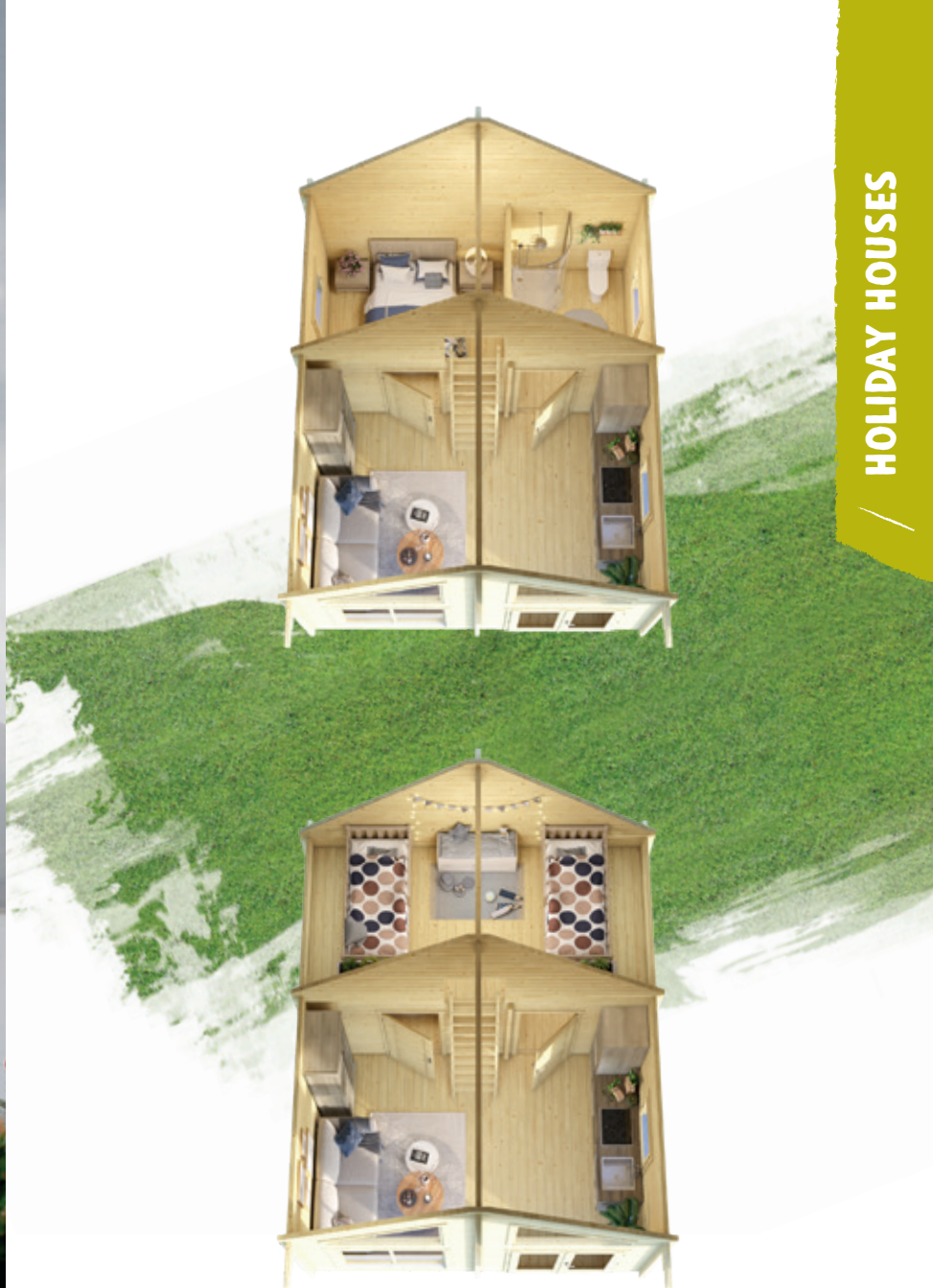

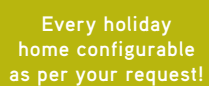
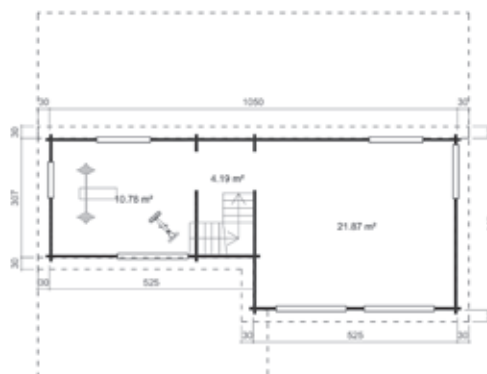
**MEKONG**98





LASITA MAJA



OUR LARGEST MODEL COMES
WITH 4 ROOMS FOR THE GROUND
AND FIRST FLOOR





CANADA



CANADA

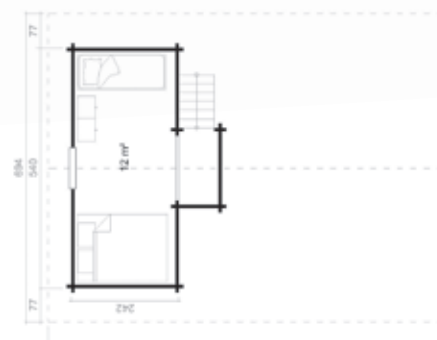

CANADA

703442

70

540 X 640

32,6 + 12

115,3

251,6

448,8

200

70

82,7 X 200

65 X 65

91,6 X 91,6 / 137,4 X 105

✓

10

25

540 X 150



MISSOURI

MISSOURI

IT PROVIDES PLENTY OF SPACE THROUGH ITS HEIGHT AND THROUGH THE ADDITIONAL FLOOR



MISSOURI	702541	70	430 X 560	22.3 ÷ 10.6	74.6	231	387.6	130	55.5	82.7 X 200	158 X 193,3	55.2 X 172.9 / 91.6 X 91.6 70.2 X 119 / 137.4 X 91.6	✓	9	20	670 X 183 430 X 110
----------	--------	----	-----------	-------------	------	-----	-------	-----	------	------------	-------------	---	---	---	----	------------------------

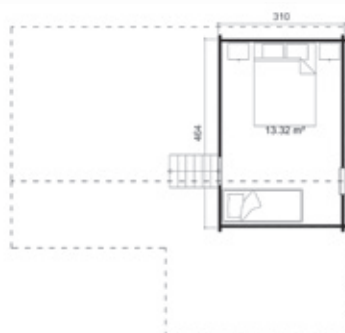

OFFERS PLENTY OF SPACE THROUGH ITS HEIGHT AND THROUGH THE ADDITIONAL FLOOR.



EUFRAT	701941	70	464 X 800	34,8 + 13,3	105,9	238	374	20	60,7	82,7 X 193,3	65 X 65	91,6 X 91,6 / 110 X 172,9	✓	10	23	241 X 800
--------	--------	----	-----------	-------------	-------	-----	-----	----	------	--------------	---------	---------------------------	---	----	----	-----------



A HOUSE WITH AN UPPER FLOOR- PERFECT FOR USE AS A SLEEPING OR STORAGE AREA



GANGES	702041	70	780 X 730	46,6 + 19,5	148,5	265	401	140	74,4	82,7 X 193,3	70,2 X 119	55,2 X 172,9 / 110 X 172,9 / 137,4 X 91,6	65 X 65	✓	10	27	780 X 140 / 387 X 203
--------	--------	----	-----------	-------------	-------	-----	-----	-----	------	--------------	------------	---	---------	---	----	----	-----------------------



MÄLAREN

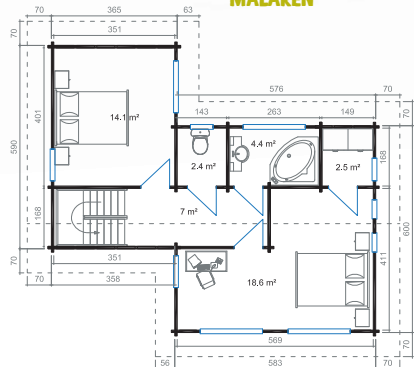

MÄLAREN

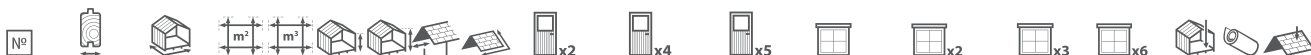
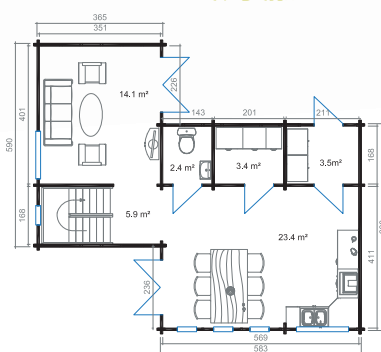

MÄLAREN	7013141	70	833 X 941	102,7	238	399	495	70	82,6	158 X 200	82,7 X 200	82,7 X 186,5	137,4 X 105	91,6 X 91,6	65 X 65 180 X 65	55,2 X 172,9	✓	9	34
---------	---------	----	-----------	-------	-----	-----	-----	----	------	-----------	------------	--------------	-------------	-------------	---------------------	--------------	---	---	----



VÄRNAMO

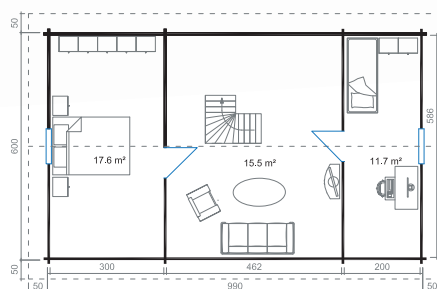
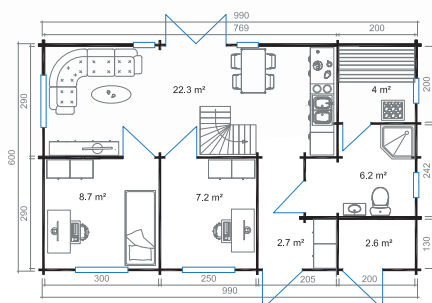

















VÄRNAMO	7013041	70	900 X 600	102,8	247	418	497	50	76,8	158 X 200 72,7 X 185,6	79 X 167,6 104 X 200	82,7 X 200	91,6 X 91,6 65 X 65 55,2 X 200	137,4 X 119	✓	7	30
---------	---------	----	-----------	-------	-----	-----	-----	----	------	---------------------------	-------------------------	------------	--------------------------------------	-------------	---	---	----



KASAI A



																	
KASAI A	7010141	70	575 X 775	36	96,7	224,4	312,8	20	53,8	82,7 X 200	137,4 X 105	91,6 X 105	✓	8	20	410 X 140	



HAN



HAN



THE LARGE TERRACE WITH RAILINGS GIVES
THIS MODEL ITS UNIQUE CHARACTER



HAN	7010441	70	575 X 625	33,5 x 13	115	278,8	394,4	220	60,6	82,7 X 200	65 X 65	137,4 X 105	91,6 X 105	✓	8	22	575 X 200
-----	---------	----	-----------	-----------	-----	-------	-------	-----	------	------------	---------	-------------	------------	---	---	----	-----------

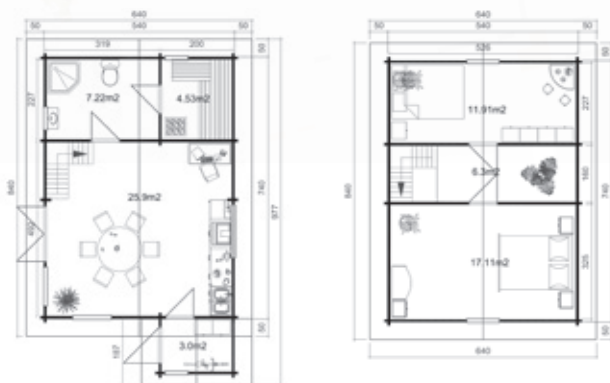

GARDEN HOUSE WITH A COMPLETE UPPER FLOOR - PERFECT AS A SECONDARY RESIDENCE



CEYLON	706142	70	540 X 740	40,7 +35,3	170,3	347	490	50	67	158 X 200 82,7 X 193	82,7 X 200	150 X 65	91,6 X 91,6 110 X 172,9	65 X 65	✓	10	28	
--------	--------	----	-----------	------------	-------	-----	-----	----	----	-------------------------	------------	----------	----------------------------	---------	---	----	----	--



Every holiday home configurable as per your request!



GROSSGLOCKNER 70	7011148	70	540 X 640	32,4 ÷ 12	122,7	279	476	200	69,8	82,7 X 200	91,6 X 105 137,4 X 105	110 X 172,9 65 X 65	✓	9	26	✓
GROSSGLOCKNER 92	920148	92	540 X 640	31,7 ÷ 11,6	119,7	279	476	200	69,8	82,7 X 200	91,6 X 105 137,4 X 105	110 X 172,9 65 X 65	✓	9	26	✓



UPPER FLOOR WITH 2 ROOMS
IDEAL AS OFFICE OR BEDROOM



	Nº	Model	Dimensions (L x W)	Floor Area (m²)	Volume (m³)	Height (cm)	Roof Pitch	Roof Area (m²)	Door (cm)	Door x5 (cm)	Window (cm)	Window x2 (cm)	Window x4 (cm)	Staircase	Other	8	23
MATTERHORN 70	7011248	70	540 X 740	37,6÷ 35,2	164,9	360	517	50	61,57	158 X 193,3	82,7 X 193,3	65 X 65	110 X 172,9 91,6 X 91,6	120 X 65	✓	8	23
MATTERHORN 92	920248	92	540 X 740	36,9÷ 33,3	161,8	360	517	50	61,57	158 X 193,3	82,7 X 193,3	65 X 65	110 X 172,9 91,6 X 91,6	120 X 65	✓	8	23



MODERN HOLIDAY/LEISURE HOUSE WITH A
LARGE GLASS FRONT AND A BI-FOLD DOOR

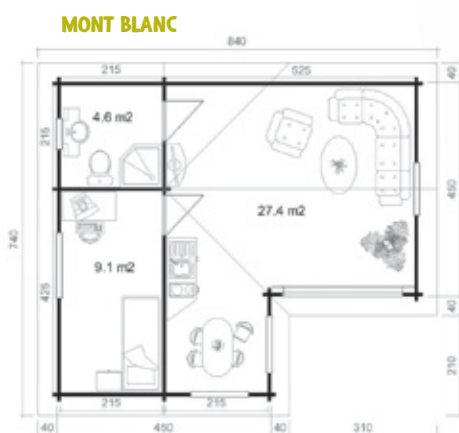

Every holiday home
configurable as per
your request!



MONT BLANC 70	7011348	70	660 X 760	41,1	118,8	231	347	40	58,7	254 X 200	82,7 X 200	110 X 172,9 / 65 X 65 137,4 X 105	120 X 65	✓	7	25	✓
MONT BLANC 92	920348	92	660 X 760	40	117	231	347	40	58,7	254 X 200	82,7 X 200	110 X 172,9 / 65 X 65 137,4 X 105	120 X 65	✓	7	25	✓

EXETER 1

TEMPERED
GLASS

PLATINUM



Optional mirroring



With a high-quality folding door

EXETER 1



EXETER 1	7012202	70	390 X 524	18,83	45,45	238	245	120	30,36	260 X 200	82,7 X 193,3	51 X 51 / 150 X 51	55,2 X 172,9	✓	3	390 X 120
----------	---------	----	-----------	-------	-------	-----	-----	-----	-------	-----------	--------------	--------------------	--------------	---	---	-----------



Optional mirroring



Every holiday home configurable as per your request!

EXETER 2



<div><div><div><div><div></div><div></div></div><div><div></div><div></div></div></div><div><div></div><div></div></div><div><div></div><div></div></div><div><div></div><div></div></div><div><div></div><div></div></div><div><div></div><div></div></div><div><div></div><div></div></div><div><div></div><div></div></div><div><div></div><div></div></div><div><div></div><div></div></div><div><div></div><div></div></div><div><div></div><div></div></div><div><div></div><div></div></div><div><div></div><div></div></div><div><div></div><div></div></div></div></div>															
EXETER 2	7012302	70	390 X 397	14,94	36,06	238	245	120	24,65	260 X 200	55,2 X 172,9	x3	✓	3	390 X 120

STAFFORDSHIRE 1

TEMPERED
GLASS

PLATINUM

Optional mirroring

STAFFORDSHIRE 2

TEMPERED
GLASS

PLATINUM

STAFFORDSHIRE 1

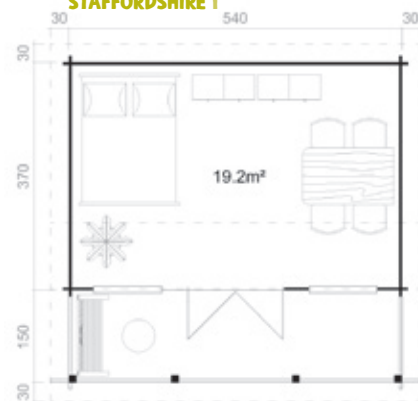

STAFFORDSHIRE 2

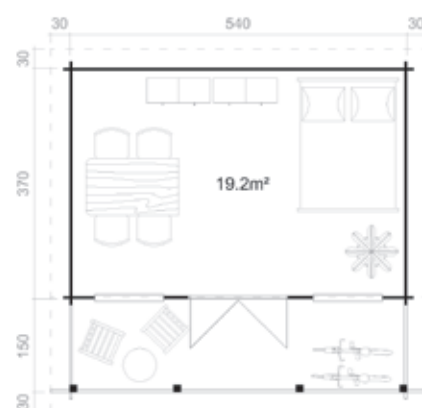

STAFFORDSHIRE 1



STAFFORDSHIRE 2



	Nº			m²	m³										
STAFFORDSHIRE 1	4421602	44	540 X 370	19,19	55,45	248	306	180	36,8	158 X 200	120 X 132	✓	4	14	540 X 150
STAFFORDSHIRE 1	7012402	70	540 X 370	18,73	49,02	218	306	180	36,8	158 X 200	120 X 132	✓	4	14	540 X 150
STAFFORDSHIRE 2	4421702	44	540 X 370	19,19	46,97	218	245	180	35,05	158 X 200	120 X 132	✓	4	13	540 X 150
STAFFORDSHIRE 2	7012502	70	540 X 370	18,73	43,29	218	245	180	35,05	158 X 200	120 X 132	✓	4	13	540 X 150



ELBA 70

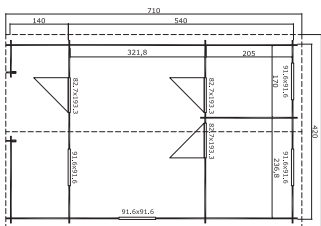

Your little
holiday home
for the weekend!

	Nº	Image	Model	Area (m²)	Volume (m³)	Length (m)	Width (m)	Height (m)	Weight (kg)	Roof Area (m²)	Door (x3)	Window (x4)	Accessories	Extras	Options
ELBA 44	441302	44	420 X 680	27,6	66,9	218	265	150	35	82,7 X 193,3	91,6 X 91,6	✓	3	13	✓
ELBA 70	701002	70	420 X 680	27,6	66,9	218	265	150	35	82,7 X 193,3	91,6 X 91,6	✓	3	14	✓

LYNDHURST

TEMPERED GLASS

DIAMOND



In 70 mm wall thickness with a high quality bi-fold door.

LYNDHURST

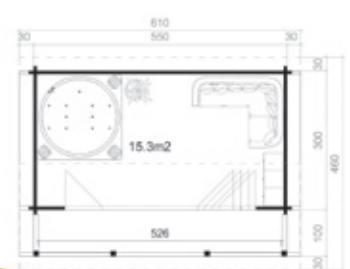

LYNDHURST	7011902	70	550 X 400	15,3	35,9	224	245	30	15,3	410 X 200	-	✓	6	11



Garden house with an additional loft.



TAHITI 70



Our Tahiti model is perfect for your weekend in your garden.
It has two rooms and a practical loft area.



TAHITI 70	701302	70	390 X 540	16,8	51,9	258	360	20	29	82,7 X 193,3	137,4 X 91,6	91,6 X 91,6	✓	4	12
-----------	--------	----	-----------	------	------	-----	-----	----	----	--------------	--------------	-------------	---	---	----

ZANZIBAR 1

TEMPERED
GLASS

PLATINUM



In 70 mm wall thickness, optional sleeping loft with 8.8sqm of floor space.











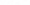
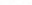



Optional mirroring



ZANZIBAR 1



You can create more room and more comfort by extending your living area with an additional mezzanine. The minimum lateral height is 90 cm and 115 cm under the ridge.

															
ZANZIBAR 1	700702	70	485 X 390	17,7	45,2	218	292		150	31,4	158 X 193,3	91,6 X 91,6 / 137,4 X 91,6		3	12
MEZZANINE KIT	700797	70	-	-	-	-	-	-	-	-	-	65 X 65	-	-	-

ZANZIBAR 4

TEMPERED
GLASS

PLATINUM

HOLIDAY HOUSES

In 70 mm
wall thickness.

Optional mirroring

ZANZIBAR 4

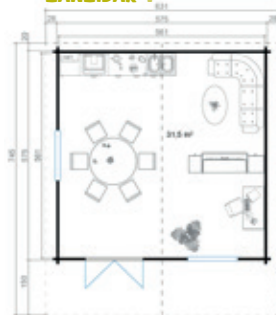

Solidely built -
Joy for
many years



ZANZIBAR 4	700902	70	575 X 575	31,5	80,3	218	306	150	49,2	158 X 193,3	137,4 X 91,6	✓	5	18
------------	--------	----	-----------	------	------	-----	-----	-----	------	-------------	--------------	---	---	----



ÖREGRUND

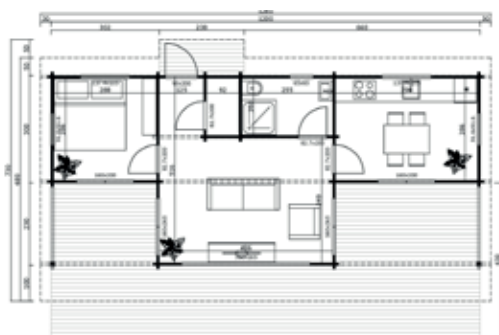

ÖREGRUND

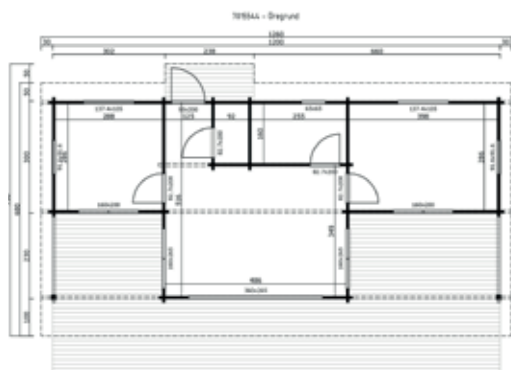

ÖREGRUND	7015544	70	530X1200	45.1+42.5	191,43	272	312,8	100	88,83	900X200 / 160X200 X2 / 160X265 X2 / 827X200 X4	91.6X91.6 X2 / 137.4X105 X2 / 65X65 / 360X265	8	-	✓
ÖREGRUND	9215544	92	530X1200	44.3+42.5	191,43	272	312,8	100	88,83	900X200 / 160X200 X2 / 160X265 X2 / 827X200 X4	91.6X91.6 X2 / 137.4X105 X2 / 65X65 / 360X265	8	-	✓



MODERN WEEKEND HOUSE WITH LOTS OF SPACE WHERE YOU CAN ENTERTAIN, RELAX, AND LET THE LIGHT FLOOD IN.





ÖSTERSUND

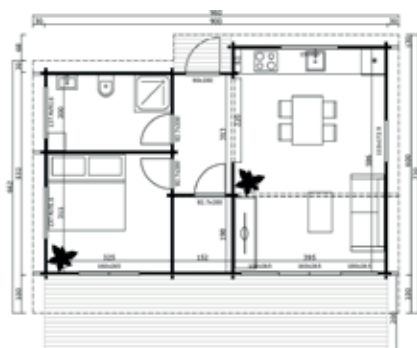

ÖSTERSUND

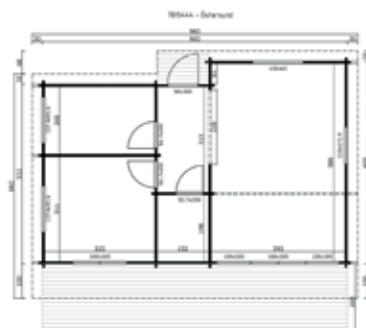

	Nº	70	92	600X900	48.6+19.5	162,4	276	310,1	100	68,13	160X265 X2/ 90X200 / 82.7X200 X3	100X265 X2 / 110X172.9 / 150X65 / 137.4X91.6 X2	9	-	✓
ÖSTERSUND	7015444	70		600X900	48.6+19.5	162,4	276	310,1	100	68,13	160X265 X2/ 90X200 / 82.7X200 X3	100X265 X2 / 110X172.9 / 150X65 / 137.4X91.6 X2	9	-	✓
ÖSTERSUND	9215444	92		600X900	47.9+19.5	162,4	276	310,1	100	68,13	160X265 X2/ 90X200 / 82.7X200 X3	100X265 X2 / 110X172.9 / 150X65 / 137.4X91.6 X2	9	-	✓



A MODERN WEEKEND HOUSE WITH
A LARGE WINDOWS AND WITH HIGH
QUALITY SLIDING DOOR



CHILDREN'S PLAY HOUSES

Our modular playhouses bring funtime for your children. Elaborate details, flexible extensions and elegant designs make little hearts beat faster and render the leisure time spent in open air the highlight of every day.

The playhouses are available as a base model and can be equipped with practical extension kits or converted to create your own play world in your garden. Wait no longer and let your childhood dreams come true.



Includes an additional floor, ladder, window shutters and flower boxes.



Light grey



Carbon grey



Glacier green



Falu red

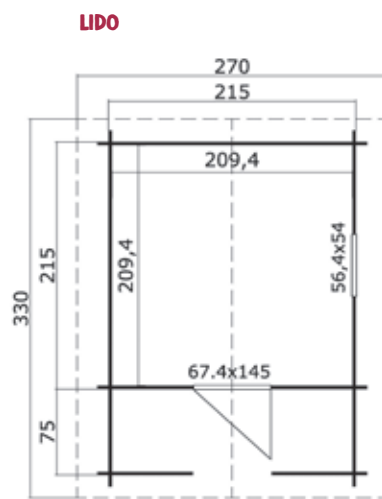

HIGH-END PLAYHOUSE, WHICH IS LARGE ENOUGH TO ALLOW YOUR KIDS TO ENJOY THEIR PLAY-TIME FOR MANY YEARS TO COME.

LIDO

*Colour for illustration only

LIDO	284799	28	215 X 215	4,4	8,1	160	211	95	9,9	67,4 X 145	56,4 X 54	x2	✓	3	5	215 X 75

*Colour for illustration only

ACCESSORIES

TERRACES



	Nº			m²	
TERRACE 28 3013	285300	28	300 X 120	3,4	✓
TERRACE 40 3613	4018600	40	360 X 120	3,9	✓
TERRACE 40 3913	4018700	40	390 X 120	4,2	✓
TERRACE 40 48513	4018800	40	485 X 120	5,3	✓

THE BAR



	Nº		
BARELEMENT	991900	190 X 65	102

ROOF EXTENSIONS



Extension
with side wall.

	Nº			m²	m³					
EXTENSION 90 X 240 A	280700	-	90 X 240	2	3,5	166	186	2,6	1	2
EXTENSION 90 X 300 A	285200	-	90 X 300	2,5	4,4	166	186	3,3	1	2
EXTENSION 90 X 240 B	9901600	19	90 X 240	2	3,5	166	186	2,6	1	2
EXTENSION 90 X 300 B	9901700	19	90 X 300	2,5	4,4	166	186	3,3	1	2

ACCESSORIES

EAVES GUTTERS



Various sets for garden houses up to a depth of 490cm consisting of eaves gutters, gutter holders, outlets, downpipes, downpipe holders, fixings and shoes made of galvanised steel, brown coating, diameter 10cm.

	Nº	SUITABLE FOR ROOF LENGTH
MODEL A EXCL. PIPE	35807	180 - 219 CM
MODEL A INCL. PIPE	35808	180 - 219 CM
MODEL B EXCL. PIPE	35809	220 - 259 CM
MODEL B INCL. PIPE	35810	220 - 259 CM
MODEL C INCL. PIPE	35810	260 - 300 CM
MODEL D INCL. PIPE	35812	301 - 349 CM
MODEL E INCL. PIPE	35813	350 - 390 CM
MODEL F INCL. PIPE	35814	400 - 490 CM

SOLAR LIGHT KIT



Lithium battery solar charger through a set device transfers solar energy into electrical energy.

It helps to solve the basic demand for electricity in your log cabin (lighting, digital products charge etc.)

	Nº
SOLAR LIGHT KIT	33020

FLOWER BOXES



	Nº
FOR SINGLE WINDOW	990600
FOR DOUBLE WINDOW	990800

WINDOW SHUTTERS



Available for single-or double window

	Nº
WINDOW SHUTTERS	994300
SHUTTERS FOR WINDOW 540X540	994400
SHUTTERS FOR WINDOW 685X882	994500
SHUTTERS FOR WINDOW 770X770	994600
SHUTTERS FOR WINDOW 685X882	994700
SHUTTERS FOR WINDOW 770X990	994800
SHUTTERS FOR WINDOW 882X1110	994900
SHUTTERS FOR WINDOW 882X1110	995000
SHUTTERS FOR OUTWARD OPENING WINDOW 564X540	995100

DOOR HANDLES „REGENT PLUS“



Upgrade your cabin with...

	Nº
HANDLE FOR WINDOW	992100
HANDLE FOR DOOR	992000

ACCESSORIES

ROOFING FELT BASIC

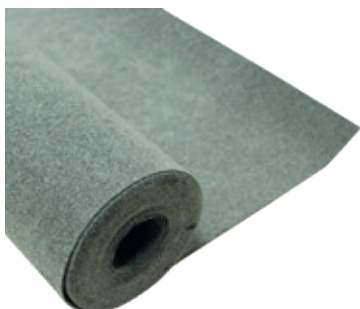
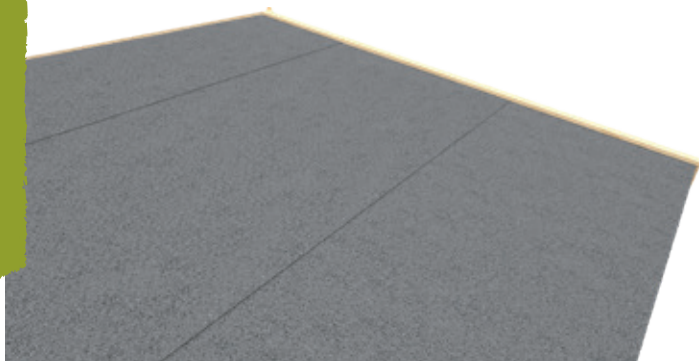

Suitable for short-term use or as an underlayer with other roofing materials. Available in classic gray. Each roll contains 10 or 15m² of roof felt.

	Nº	m ²
ROLL 10	261	10
ROLL 15	262	15

ROOFING FELT PREMIUM



Polymer bitumen membrane is ideal for long-lasting waterproofing of roofs. Available in 4 most preferred colours. Each roll contains 15m² of premium quality roof felt.

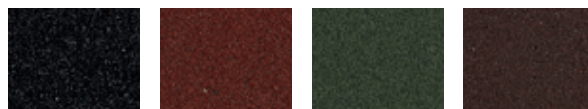

	Nº	m ²		Nº	m ²
BLACK	37449	15	GREEN	37452	15
RED	37451	15	BROWN	37453	15

ROOF SHINGLES

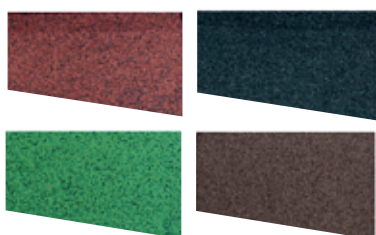
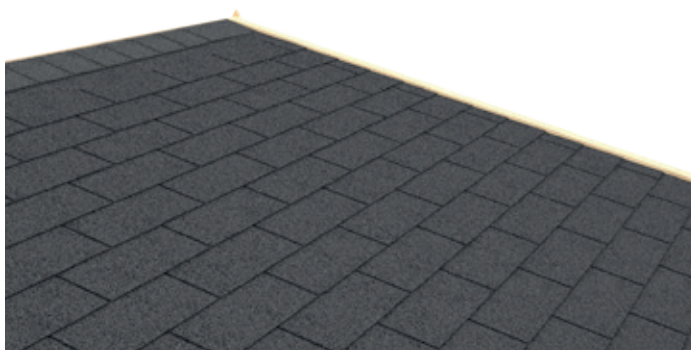

3-Tab roof shingles are one of the most commonly used shingle styles. They are easy to assemble and create the typical rectangular shingle look you see while driving by homes. Ideal as a reliable and modern roofing material, which is available in 4 most preferred colours. Each package contains 3m² of roof shingles.

	Nº	m ²
RED	16274	3
BLACK	263	3
GREEN	16275	3
BROWN	264	3

ONDULINE



Self adhesive roofing membrane, perfect for flat roof buildings. Make sure that the roofing membrane is glued to the clean roof boards. Each roll contains 5m².

	Nº	m ²
GRAY	37470	5

ACCESSORIES

ADDITIONAL DOORS AND WINDOWS



ALL THE DOORS AND WINDOWS USED IN OUR CABINS CAN BE ORDERED EXTRA TO ADAPT YOUR CABIN WITH IT'S ACTUAL USE. PLEASE DON'T HESITATE TO ASK ABOUT THE OPTIONS AND DELIVERY TIMES FROM OUR SALES REPRESENTATIVES IN YOUR COUNTRY.

MAINTENANCE PAINT

If you have bought an already industrial coated cabin from Lasita you can buy colour for maintenance and repainting at the specialized retail markets or from our direct source at OSMO. This is the original used colour and fits perfectly to your cabin.



© OSMO

GOOD TO KNOW

What should I consider before ordering a garden building?

You should consider that the assembly of a garden building on site can be a subject to local regulations depending on which country you are in. It is best to inquire at the locally responsible authority about the respectively applicable requirements before placing your order. For some of our models static calculations are available on request.

How will my garden building be delivered?

Generally we deliver our garden houses and assembly kits to our dealers. On request it is possible to deliver your assembly kit "kerbside" to your home. Please be aware that access for a very large truck must be guaranteed and you must be reachable via phone to arrange the delivery. A sufficiently solid surface must be available to deliver the cabin on.

What kind of foundation should I have to erect a building on?

A foundation is the lowest and most supporting layer of a building. Its uneven settling causes loss of stability and affects the entire building. The choice of foundation should be based on the geographical peculiarities of the location (e.g. the soil and the freezing limit of the ground) in which the garden house will be built and the nature of the particular building. We recommend the following types of foundations: block foundation, strip footing, pier foundation or base slab. It is important to ensure that when building the garden building the base frame is level and square. Depending on the type of building, the cross-sections and installation methods of a base frame may be different – check this in our installation manual. In order to prevent complaints later on, we recommend to consult an expert.

What tools are required for the assembly of my garden building?

In order to assemble your garden house, you will need among others the following tools: Phillips or Torx screwdriver, cordless screwdriver, wood drill, drilling machine, combination pliers, carpet knife, saw, folding ruler, bubble level, cord, hammer, pencil, glue, clamp and a ladder. All the hardware needed for assembly of the building are enclosed in the assembly kit. Please consider that the assembly will require more than one person.

What do I need to consider before the assembly of my garden building?

Before you start the assembly of your house, please read the assembly instructions. This will prevent problems and save time during the assembly. Before the assembly, please check if all parts are present with the help of the piece list and look out for possible transport damages. Of course, we take greatest possible care during

the production and during packaging. Nevertheless, it is possible that sometimes errors occur or that parts are damaged during transport.

Please pay attention, wood is a natural material and there can be differences in its colour, or elements of it may be a bit twisted or bent. These peculiarities will not hamper the installation of the garden house. Besides ecological cleanness, wood is considered to be the most appealing construction material. Every wooden element in a garden house is unique and special in regard to its texture and to the size and shape of the branches. The stability of the product is not impaired by intact or ingrown knots, resin pockets, small fissures or cracks caused by the drying process of each element if they have not penetrated through it. There may be finger-jointed elements in your garden house which, during processing, have become even more stable in terms of the twisting and bending which could occur in the future. Wood is a living material which can expand and shrink. That's the reason why our log buildings (with the exception of system houses) must NOT be fixed with screws in their walls or doors and windows.

What happens if my garden building arrives incomplete or damaged?

In order to avoid possible problems during the assembly carried out by yourself or the building company of your choice, we recommend that you inspect the delivery for its completeness with the help of the piece list before assembly. This inspection must be carried out within 14 days after delivery to your place. Please submit a complaint to our dealer who sold you the building accompanied by one or more photos, a description of deficiency, the article and serial numbers of the product (as marked on the assembly instruction and on the label attached to the packing). The best option might be to prove the complaint with the returned part and we will gladly provide a spare part or a replacement. As a matter of principle we do not refund costs for repairs, materials and travel.

What should I use to treat my building?

After installation, in order to prevent discolouration, bending and expansion, the garden house should be finished in its entirety with a wood preservative (including windows and doors). Regarding the choice of wood preservative, we recommend consulting an expert/paint seller or our dealer in your country. We recommend you renew the protective coats at least every two years. This will provide lasting protection for your garden building for many years to come.

What kind of roofing material shall I use? Is it included?

As a general rule, if the roofing is included in the delivery contents, we supply bitumen roofing felt for a temporary roofing. We can also supply various high-quality bitumen roof shingles. This will protect your roof for a longer time period. Selected houses – especially some models with flat roofs – are delivered as a standard with EPDM roof covering, rainwater pipe and pipe connectors. Please pay attention to the delivery contents of each model in this catalogue which points out if the roofing material is included or optional.

MAINTENANCE INSTRUCTIONS FOR LASITA MAJA COLOUR SYSTEM

To enjoy your painted log house for a long time, it is essential to ensure regular and professional maintenance of its coating. If you do this maintenance yourself, please read the general safety precautions in our installation instructions and also the corresponding maintenance instructions.

If the paint coating suffers from minor damage during installation or delivery, please use the supplied paint to repair this damage. This paint supply is intended for repairing minor mechanical damage or re-coating log/board ends (spot repair) rather than painting large areas. If you need paint for refinishing, please contact your dealer who will assist you.

First and foremost, it is important to clean the paint coating regularly. This extends the useful life of your product notably. Inspect your garden house annually for possible contamination, algae growth, damage, loose elements or colour degradation. It is also important to keep the paint surface free of vegetation or plants as these would prevent adequate ventilation and cause moistness. Pay special attention to the sides facing the sun which are most exposed to UV radiation and may need more attention.

Maintenance/refinishing:

1. Clean the surfaces to be maintained with a suitable cleaning agent.
2. Remove loose or porous layers of paint - appropriate abrasive material is recommended.
3. Coat the painted surface using a suitable brush. Make sure to apply rich and even layers of paint.
4. Let the paint dry properly (at least 48h).
5. Apply a second coat to the refinished area (note that less paint is needed this time) to seal the surface.

Proper maintenance allows you to enjoy your garden house for many years to come. If you have any further questions, please contact us or your dealer.



EVERY DETAIL MATTERS



Wide selection of Garden Buildings in **excellent Nordic quality** with the wall thicknesses from 14 mm up to 94 mm



Impregnated terrace boards



Windproof **wall log angle profiles** made with wind-tight chalet connection



All the fillets, beadings and mouldings are part of the delivery contents



Impregnated sub-construction protects the building against humidity and extends its durability



Assembly instructions and hardware are part of the delivery contents



15 / 18 mm floor boards (for holiday houses alternatively also available in 28 mm)



Wooden storm protection or threaded rods (depending on the model) protect your garden house against strong wind



18 mm roof boards
(15 mm for "Basic")



High quality windows and doors



High quality windows and doors
Windows and doors with real glass: single glazing 4mm or double glazing (various thicknesses available) depending on the mode



All doors are **lockable**



Improved heat insulation of **windows and doors with a silicone gasket** (applicable to Gold, Platinum, Diamond+, Diamond++)



Doors **with low threshold**



Windows (starting from "Gold ") are supplied with an **Aluminium water gutters** to prevent water from entering



1 or 2 hand tilt-and-turn windows (depending on the model), exception: horizontal, fixed windows and outward opening windows



The houses are **packed very carefully for the transport**. UV-resistant foils and stable pallets protect the garden houses against humidity and damage during transport



Visit us online
WWW.LASITA.COM



Flash this code
to know more
about us.



Check out our
YouTube channel.